

Intelligent Pro Steam Press

Instruction Manual

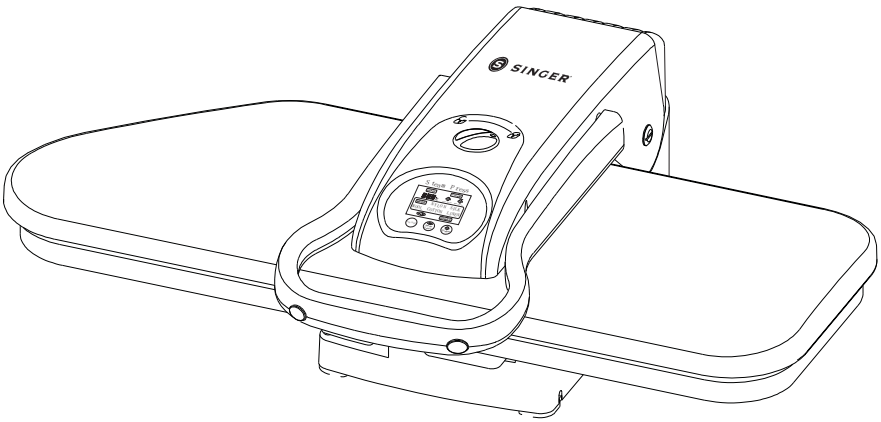

Please read all instructions before use.

IMPORTANT SAFETY INSTRUCTIONS

PLEASE READ THIS MANUAL CAREFULLY BEFORE USING AND KEEP IT FOR FUTURE REFERENCE.

When using electrical appliances, especially when children are present, basic safety precautions should always be taken, including the following: READ ALL INSTRUCTIONS BEFORE USING - KEEP AWAY FROM WATER

DANGER Any appliance is electrically live even when the switch is off.

To reduce the risk of death by electric shock:

1. Always unplug Steam Press immediately after using.
2. Do not place or store appliance where it can fall or be pulled into a tub or sink.
3. Do not place or drop in water or other liquid.
4. If appliance falls in water, unplug it immediately. Do not reach into water.

WARNING To reduce the risk of burns, electrocution, fire, or injury to persons:

1. This appliance should never be left unattended when plugged in.
2. Close supervision is necessary when this appliance is used by or near children or the physically challenged. Unsupervised use could result in fire or personal injury.
3. Use this appliance only for its intended use as described in this manual. Do not use attachments not recommended by the manufacturer.
4. This appliance can be used by children aged from 8 years and above and persons with reduced physical, sensory or mental capabilities or lack of experience and knowledge if they have been given supervision or instruction concerning use of the appliance in a safe way and understand the hazards involved. Children shall not play with the appliance. Cleaning and user maintenance shall not be made by children without supervision.
5. If the supply cord is damaged, it must be replaced by the manufacturer, its service agent or a similarly qualified person in order to avoid a hazard.
6. Never operate this appliance if it has a damaged cord or plug, if it is not working properly, if it has been dropped or damaged, or it has been dropped in water. Do not attempt to repair the appliance. Incorrect reassembly or repair could cause a risk of fire, electric shock, or injury to persons when the appliance is used. Return appliance to an authorized service center for examination.
7. Keep cord away from heated surfaces. Do not allow cord to contact heated surfaces. Do not pull or twist cord. Let appliance cool completely before putting away.
8. Never drop or insert any object into any opening.
9. Do not use outdoors or operate where aerosol(spray)products are being used or where oxygen is being administered.
10. Do not use an extension cord to operate appliance.
11. Surfaces of this appliance may be hot when in use. Do not let eyes or bare skin touch heated surfaces.
12. Always turn the On/Off Switch to "Off" before plugging in or unplugging unit.
13. Always let appliance cool for at least thirty minutes before storing.
14. Do not move appliance without unplugging it.
15. Unplug this appliance before filling with water. Do not overfill.

-
16. While emitting steam, this appliance may cause burns if held too close to the skin, scalp or eyes, or if it is used incorrectly. To reduce risk of contact with hot water as it escapes through steam vents, test appliance before each use by holding and testing it away from body.
 17. Do not operate steamer without properly filling the Water Tank.
 18. Never yank cord to disconnect from outlet. Instead, grasp plug and pull to disconnect.
 19. USE CAUTION - burns could occur from touching hot metal parts, or proximity to hot water or steam. Do not turn unit upside down - there may be hot water in Tank.
 20. To reduce likelihood of circuit overload, do not operate another high wattage appliance on the same circuit.
 21. Use distilled or demineralized water in Steam Press.
 22. Do not let cord hang over the edge of counter.
 23. Always put appliance on a secure, level surface, such as a table or counter, when using.
 24. This Steam Press is for household use only.
 25. Do not allow cord to touch hot surfaces. Let appliance cool completely before putting away. Loop cord loosely around appliance when storing.
 26. This appliance must be grounded. Do not alter the plug or attempt to defeat this feature.
 27. Before plugging in Steam Press, be sure electrical information on the label agrees with your power supply.
 28. Disconnect Steam Press when not in use and when the Ironing Board Cover is being replaced.

SAVE THESE INSTRUCTIONS!
FOR HOUSEHOLD USE ONLY

Product Information

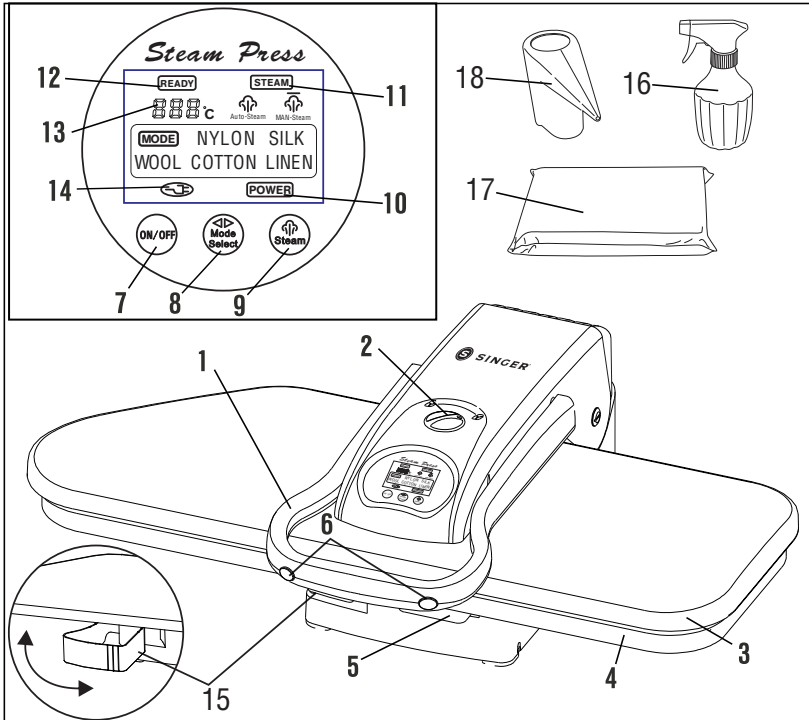

The following features and accessories are included with your steam press. Carefully inspect packaging material as some parts are shipped inside Styrofoam packaging. To obtain possible missing parts, refer to Consumer Support section of this manual.



FEATURES AND ACCESSORIES

- | | |
|-------------------------------|---------------------------------|
| 1. Handle | 10. Power Indicator Light |
| 2. Locking Knob | 11. Steam Ready Indicator Light |
| 3. Pressing Plate | 12. Pressing Indicator Light |
| 4. Ironing Board | 13. Temperature Digits |
| 5. Water Tank | 14. Power Cord Indicator Light |
| 6. Steam Burst Buttons | 15. Storage Compartment |
| 7. On/Off Button | 16. Spray Bottle |
| 8. Temperature Control Button | 17. Pressing Cushion |
| 9. Steam Selector Button | 18. Measuring Cup |

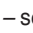
FEATURES & ACCESSORIES DESCRIPTIONS

1. *Handle* – raises and lowers the Pressing Plate. Also used to carry the unit.
2. *Locking Knob* – locks the Pressing Plate and Ironing Board together.
3. *Pressing Plate* – large temperature-controlled surface that heats and presses fabric.
4. *Ironing Board* – padded surface onto which fabric is placed for pressing.
5. *Water Tank* – holds the water needed to produce steam.
6. *Steam Burst Buttons* – located on either side of the Handle and produces a burst of steam when pressed.
7. *On/Off Button* – activates and deactivates the unit.
8. *Temperature Control* – used to select a desired temperature by cycling through the list of choices above the buttons. Adjust the Temperature Control until the Indicator Light beneath your preferred material becomes illuminated.
9. *Steam Selector Button* – selects Auto Steam “” or Man Steam “”.
10. *Power Indicator Light* – illuminates when On/Off Switch is in “On” (I) position.
11. *Steam Ready Indicator Light* – illuminates when unit is ready to produce steam for use.
12. *Pressing Indicator Light* – illuminates while unit is heating to selected temperature. When light goes off, Steam Press is ready for use.
13. *Temperature Digits* – indicates Pressing Plate surface temperature.
14. *Power Cord Indicator Light* – illuminates when power is “On”.
15. *Storage Compartment* – provides a convenient place to store needlecraft items such as needles, thread and scissors.
16. *Spray Bottle* – used to moisten fabric before pressing stubborn wrinkles and heavier fabrics.
17. *Pressing Cushion* – fabric covered pad used for pressing gathered or contoured areas such as sleeves, darts, collars or yokes.
18. *Measuring Cup* – used to assist in easily filling the Water Tank (best with distilled water).

Using the Intelligent Pro Steam Press

ABOUT AUTO SHUT-OFF

The Auto Shut-Off feature includes both an Auto Shut-Off and an Auto Wake-Up. These multi-function safety features deactivate electrical power to the heater when Pressing Plate has been left closed on the Ironing Board for more than 10 seconds. Heater deactivation is signaled by a beeping sound. Heater Functionality is restored when Pressing Plate is raised back up. Power to heater will also be cut if the Pressing Plate is in raised position without use for approximately 15 minutes (once again signaled by a beeping sound) Heating ability of the unit can only be restored in this situation by pressing the ON/OFF Switch.

IMPORTANT: Auto Shut-Off does not mean power to the unit is totally cut off. Power is always on, and the Power Indicator Light will remain illuminated until On/Off Switch is set to "Off" (O) position. Unplug power cord.

FEATURES OF INTELLIGENT PRO STEAM PRESS

Your Steam Press provides clean, professional results every time!

- Pressing surface is twenty-four (24) times larger than most hand-held irons
- Can reduce ironing time up to 50%
- Multiple dry and steam settings, burst setting to remove stubborn wrinkles
- Variable temperature control
- Automatic Shut Off safety feature while open or closed with audible alert
- Power Indicator Light
- Protects delicate fabrics like silk

IMPORTANT: DO NOT PLUG IN UNIT UNTIL YOU HAVE FILLED THE WATER TANK. DO NOT ATTEMPT TO PULL WATER TANK OUT COMPLETELY. FOR HOUSEHOLD USE ONLY.

FILLING WATER TANK

1. Place Intelligent Pro Steam Press on a flat, level surface.
2. Turn Locking Knob to "Unlock" position to unlock Pressing Plate.
3. Lift up Pressing Plate using Handle. It will automatically stay in lifted position.
4. Pull Water Tank out. Note that Water Tank cannot be completely removed from unit; do not attempt to force it free.
5. Remove Water Tank Cap to expose Water Tank refill hole.
6. Using Measuring Cup (included), fill Water Tank up to the MAX (300ml - 10.144 oz) line with distilled water.
7. Replace Water Tank Cap and push Water Tank back in main unit.

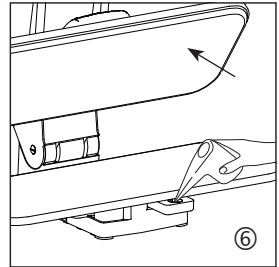

OPERATION

1. With Pressing Plate raised, plug power cord into electrical outlet, and touch On/Off Button to "On" (I) position.
2. Identify type of fabric to be pressed, then press Temperature Control Button until you reach the setting that matches that fabric. It is best to start with the most delicate fabric first. Higher heat will damage Nylon and Silks.

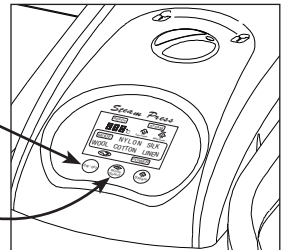

Using the Intelligent Pro Steam Press

3. Lay fabric flat on Ironing Board.
4. Intelligent Pro Steam Press is ready when Pressing Indicator Light illuminates. If pressing wool, cotton or linen you may choose to spray with a burst of steam using Steam Burst Buttons. This function is available once Steam Burst Ready Indicator Light illuminates. See “Steam” section before applying steam.
5. To press, lower Pressing Plate gently onto fabric and Ironing Board. Hold there for 8-10 seconds, then lift Pressing Plate. Repeat until you have achieved desired crease and smoothness.
NOTE: The unit will automatically turn off the Pressing Plate after 10 seconds in the closed position. A beep will emit until the unit is opened. Once the unit is opened, it will return to normal operation.
6. Once pressing tasks are complete, immediately turn On/Off Switch to “Off” (O) position and unplug power cord from electrical outlet.

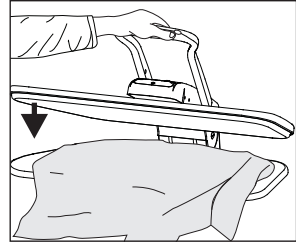
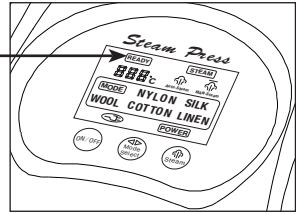

STEAM OPTIONS

MANUAL (MAN) STEAM

IMPORTANT: Do not activate Steam Burst Buttons with unit completely closed, as this may damage unit. Best results are obtained if Pressing Plate is held open approximately 3 in. (75 mm.) above Ironing Board before pressing Steam Burst Buttons. For safety reasons, do not hold Pressing Plate open more than 3 in. (75 mm.) when using Steam Burst Buttons. Only use burst of steam for 1 second for best results. If Pressing Plate is left on fabric for more than 10 seconds, it could damage fabric.

1. Hold Pressing Plate approximately 3 in. (.75 mm.) above Ironing Board.
2. Press Steam Burst Buttons to release a burst of steam onto fabric for 1 second.
3. Lower Pressing Plate onto fabric for 8-10 seconds, then raise once again.
NOTE: If Pressing Plate is left on fabric for more than 10 seconds, it could damage fabric.
4. Repeat steps 1-3 above until fabric is smooth and wrinkle-free.

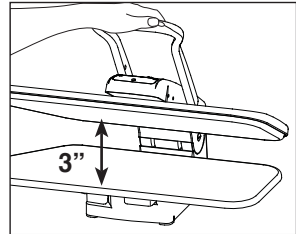

AUTO STEAM

1. Hold Pressing Plate approximately 3" above Ironing Board.
2. Press Steam Selector Button until Auto Steam “☁” illuminates. This activates Auto Steam and automatically releases a burst of steam to fabric.
3. Lower Pressing Plate onto fabric, then raise once again.
4. Repeat steps 1-3 until fabric is smooth and wrinkle-free.

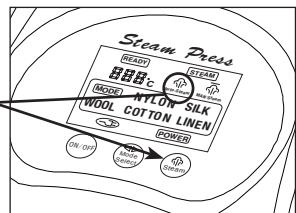

Using the Intelligent Pro Steam Press

PRESSING AND STEAMING TIPS

PRESSING PANTS

1. Place Pressing Cushion under waistband and press. Continue repositioning waistband until completely pressed.
2. To press inseam, place Pressing Cushion under area to be pressed.
3. Place pleated area on Ironing Board. Carefully fold pleats and press.

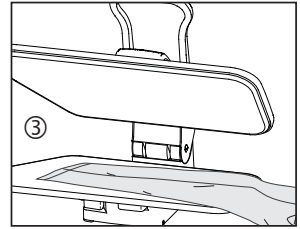
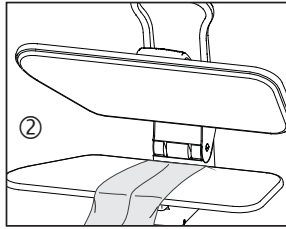
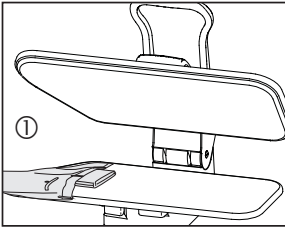

PRESSING SHIRTS AND BLOUSES

1. Place shoulder yoke on Ironing Board first and press.
2. Place sleeves on Ironing Board with the fold parallel to long seam, and press.
3. Place cuffs on end of Ironing Board, and press.
4. Place bottom of shirt behind Ironing Board by pressing the side with pocket. Pull shirt towards you as you press each section.

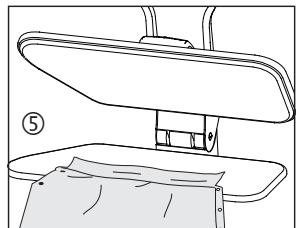
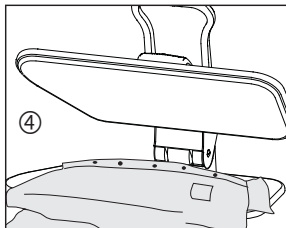
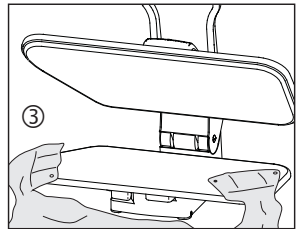
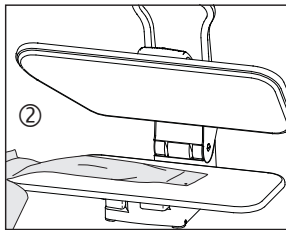

NOTE: Embroidery should be placed face down on Ironing Board to reduce wear and prevent damage to delicate areas.

5. Finish by pressing collar of shirt.

OTHER TECHNIQUES

- Placing Pressing Cushion between fabric and Pressing Plate may help with delicate fabrics.
- If you have older types of buttons or zippers, you may need to take special care to avoid melting. In order to do so, place garment face-down and cover with Pressing Cushion before pressing.
- Spray Bottle may be used to spray fabric lightly. This will help to remove stubborn wrinkles.

Using the Intelligent Pro Steam Press

- Place damp cloth over fabric before pressing. This will help with stubborn wrinkles or heavy gauge fabrics.
- To press large pieces of fabric, place entire piece behind Ironing Board. Pull fabric toward you over Ironing Board and lower Pressing Plate. Press fabric in sections until completed.
- Place embroidery face down on Ironing Board to reduce wear and prevent damage to delicate areas.

USING PRESSING CUSHION

1. For garments constructed with details such as darts, curved seams, and shoulder pads, a Pressing Cushion may be used.
2. Use Pressing Cushion in areas where no creases are desired or to shape a tailored garment.
3. Place area to be pressed on the Ironing Board.
4. Place Pressing Cushion under dart, seam, etc.
5. Making sure the area to be pressed is raised, lower Pressing Plate until it meets the raised area.
6. Do not force Pressing Plate to its lowest position. This may cause damage to the unit.

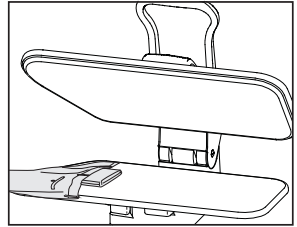

CLEANING STEAM PRESS

1. Fill Water Tank with distilled or demineralized water.
2. Place Pressing Cushion in the middle of Ironing Board.
3. Place a clean towel over Pressing Cushion and Ironing Board.
4. Set Temperature Control to the highest setting (LINEN).
5. When Steam Ready Indicator Light illuminates, lower Pressing Plate onto Pressing Cushion.
6. Press Steam Burst Button six times.
7. Allow Pressing Plate to cool.
8. Clean Pressing Plate with damp cloth. Do not use abrasive materials, as this may damage Pressing Plate.
9. Ironing Board Cover is removable for cleaning. Hand wash only with mild detergent.

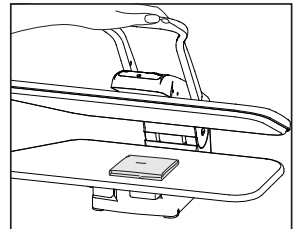

STORAGE

1. Once pressing is complete, immediately turn On/Off Button "Off" and unplug power cord from electrical outlet.
2. Allow unit to cool completely (at least 30 minutes).
3. Lower Pressing Plate down and turn Locking Knob to "Lock" position.
4. Wrap up power cord.
5. Store all accessories safely away, preferably near Intelligent Pro Steam Press.
6. Store Intelligent Pro Steam Press in a cool, dry place.
7. For long term storage, empty water from Water Tank.

Troubleshooting & Warranty

| PROBLEM | POSSIBLE CAUSE | SOLUTION |
|---|---|--|
| Unit fails to heat up and steam. Power Indicator Light does not illuminate. | Unit is not plugged in. | Plug into electrical outlet. |
| | Household Circuit Breaker/Ground Fault Interrupter has tripped or blown a fuse. | Reset Circuit Breaker/Ground Fault Interrupter, or replace fuse. If you need assistance, contact a licensed electrician. |
| Unit fails to heat up and steam. Power Indicator Light does illuminate. | Auto Shut-Off has engaged. | Refer to Auto Shut-Off section of this manual for proper procedure. |
| | Water Tank is empty. | Refill Water Tank using procedures found in this manual. |
| | Unit is damaged or malfunctioning. | Immediately cease usage and contact our Consumer Support Department. |
| Steam Burst output is weak or intermittent. | Pressing Plate needs to be cleaned. | Refer to Cleaning section of this manual for proper procedure. |

This product must be disposed of appropriately at the end of its useful life. Please contact your local council for information on waste collection services available in your area.



The meaning of the crossed-through waste bin symbol on the appliance is the product must be disposed of separately to other household waste at the end of the useful life of the appliance. The user is responsible for delivering appliance to an appropriate collection center at that time.

Appropriate separate collection for environment-friendly treatment and recycling prevents or reduces harmful effect on the environment and human health. You can obtain information on available collection services in your area by contacting your local Council waste collection department, or the retailer from which you bought the appliance.

LIMITED WARRANTY

IMPORTANT: SAVE THIS DOCUMENT AND KEEP IT IN A SAFE PLACE!

The Intelligent Pro Steam Press is warranted to be free from defects in material and workmanship.

The warranty for the Intelligent Pro Steam Press's wiring and electronic parts is for a period of one (1) year from the date of purchase.

The warranty for all other parts of the Intelligent Pro Steam Press is for a period of ninety (90) days from the date of purchase.

If the electronic parts and/or the other parts in the Intelligent Pro Steam Press, after inspection by SINGER, prove to be defective during the applicable warranty period(s), the electronic parts and/or the other parts will be repaired or replaced at SINGER's option, without charge, except for any expense associated with sending the Intelligent Pro Steam Press to SINGER.

If SINGER sends a replacement Intelligent Pro Steam Press, it will carry the remaining warranty of the original Intelligent Pro Steam Press.

Warranty

This warranty may only be used by the original consumer owner of the Intelligent Pro Steam Press and may not be transferred or assigned.

Exclusions or Limitations

- Service under this warranty may only be obtained within the country of purchase.
- The Intelligent Pro Steam Press is warranted only for normal household (non-commercial) use. This warranty does not cover defect(s) caused by abuse, lack of maintenance or other neglect, failure to follow the care, cleaning or other instructions for the Intelligent Pro Steam Press, misuse, or events beyond our control.
- ANY IMPLIED WARRANTY APPLICABLE TO THE INTELLIGENT PRO STEAM PRESS, INCLUDING WITHOUT LIMITATION THE WARRANTIES OF MERCHANTABILITY AND/OR FITNESS FOR A PARTICULAR PURPOSE, IS LIMITED IN DURATION OF THIS WRITTEN WARRANTY. SINGER SHALL NOT BE LIABLE FOR CONSEQUENTIAL ECONOMIC DAMAGES RESULTING FROM BREACH OF THIS WARRANTY OR ANY IMPLIED WARRANTY.
- SINGER does not authorize any person to create for it any obligation or liability in connection with the Intelligent Pro Steam Press and any of its parts beyond those set forth in this warranty.
- SINGER disclaims liability under this warranty for any damage or defect resulting from the use of other than SINGER parts and SINGER approved service in the repair and maintenance of the Intelligent Pro Steam Press.
- This warranty gives you specific legal rights, and you may also have other rights which vary from state to state.
- Some states do not allow limitations on how long an implied warranty lasts, so the above limitation may not apply to you.
- Some states do not allow the exclusion or limitation of incidental or consequential damages, so the above limitation or exclusion may not apply to you.

Service under the Warranty may be obtained by returning the Intelligent Pro Steam Press with:

1. This original warranty document; and
2. Proof of purchase (such as the purchase receipt) to:

SINGER AUSTRALIA
ATT: Service Department
PO BOX 254
Seven Hills 1730

If you have any questions regarding these warranties, please contact:

SINGER AUSTRALIA
(02) 8811 1900
Email: info@singerco.com.au
ATT: Customer service
Unit 1A / 167 Prospect Highway
Seven Hills, NSW 2147

Or, visit our website for more information: singerco.com.au



SINGER®

Singer and the Cameo “S” Design are trademarks of The Singer Company Limited S.a.r.l. or its Affiliates.
© 2019 The Singer Company Limited S.a.r.l. or its Affiliates. All rights reserved.

Technical Specifications*

Adapter Input: 220-240V~, 50-60Hz

Power: *For Model ESP36:* 2000-2400watts

For Model ESP36T1.01AU: 2200-2618watts

**Please refer to product for actual rating, depending on region.*