



Mclocks

More than
a clock

ATOM

INSTALLATION - INSTALLATION GUIDE

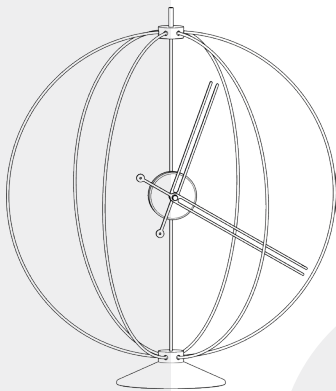

www.mclocks.store



Scan QR Code
For Instructions



Thank you for choosing Mclocks. You can access the installation video related to the Atom model by scanning the QR code on the homepage with your mobile phone's camera. All the necessary information is available in the installation guide and video. The mechanism is very silent.

-  [mclocks.store](https://www.instagram.com/mclocks.store)
-  www.mclocks.store
-  info@mclocks.store

CONTENTS

Hour Hand



Minute Hand



Body Shaft



Fiberglass Rod (x6)



Connector
Cap



Head
Connector



Allen
Key



Base

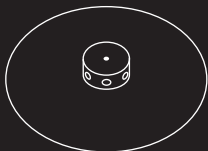

Body



Clock
Mechanism



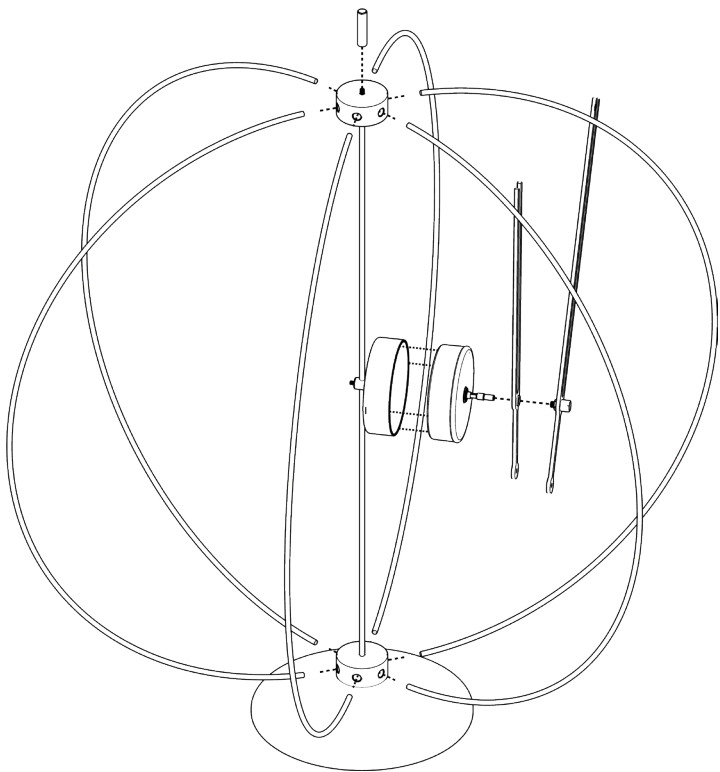



BEFORE YOU BEGIN

- Make sure you have read the manual. Follow instructions to complete your set-up.
- This product has been tested and run for 24 hours before being delivered to you. This is to ensure your product is of the highest quality.
- The Mclocks package includes an 'hour' hand, and a 'minute' hand. The shorter hand is the hour hand and the longer hand is the minute hand. The product does not consist of a 'seconds' hand.
- **DO NOT** in any circumstance move the hour hand manually. When adjusting the time you must **ONLY** move the minute hand.
- The mechanism is very silent.

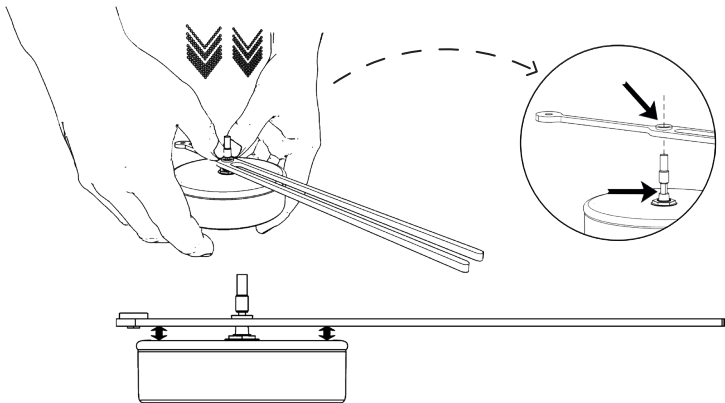

1

Insert the hour hand to the mechanism by pressing down until the metal nut piece at the center, facing upwards, fits into the indicated area as shown by the arrow. Ensure the hand is parallel to the clock mechanism (see image above).

Ensure the hour hand does not move from this position during setup of the clock.

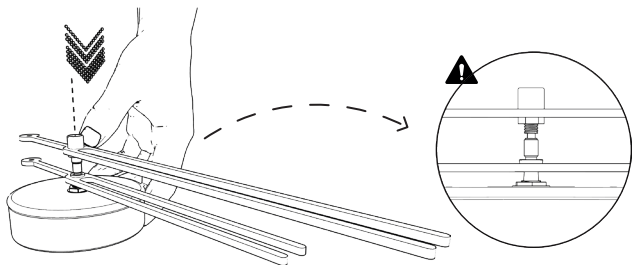

2

Attach the minute hand in line with the hour hand.

Press down from the connection point of the minute hand and not from the ends.



See image for the correct installation method of the hour and minute hands.

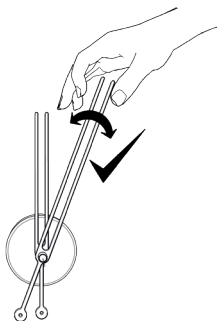

⚠ DO NOT in any circumstance move the hour hand manually. When adjusting the time you must **ONLY** move the minute hand.

⚠ When adjusting the time, only move the minute hand. The minute hand can be moved both clockwise and counterclockwise.

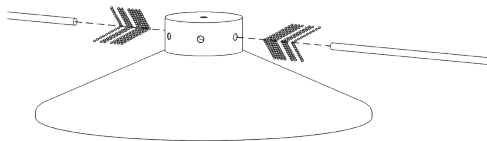

3

Insert two fiberglass rods as shown in the diagram.

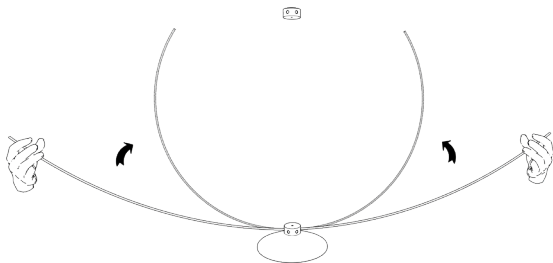

4

Bend the fiberglass rods to connect both rod ends to the head connector.

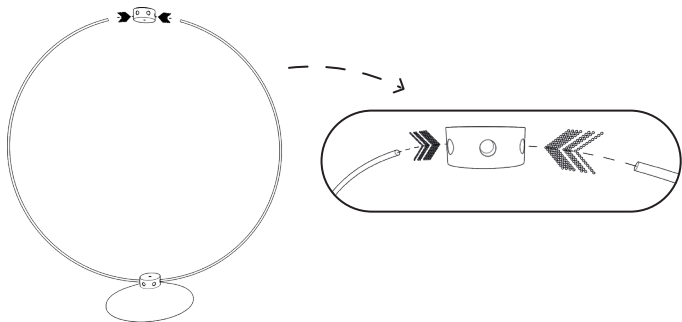

5 Ensure both ends are in place.



6 Attach the remaining fiberglass rods in the same fashion mentioned above.

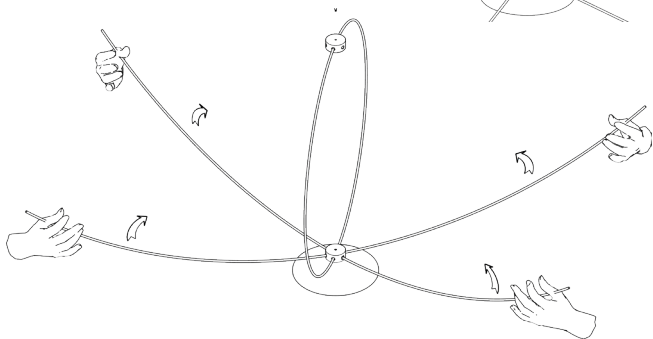

7 Repeat steps with all rods.

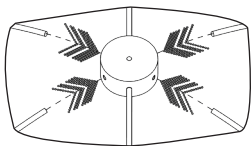
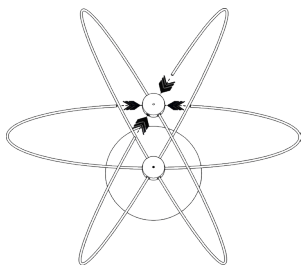

8

Complete rod installation and ensure all ends are firmly in place.

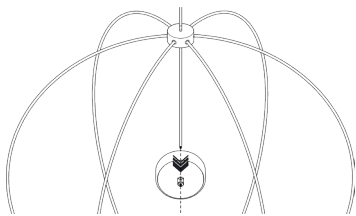
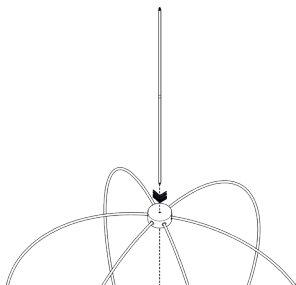

9

shaft through the head connector.

Pass the shaft through the slot of the body. Insert the body

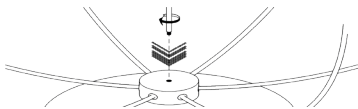
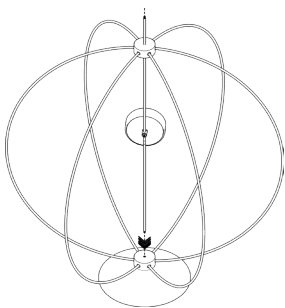

10

Set the shaft in place by screwing the bottom end to the base as seen in the image.

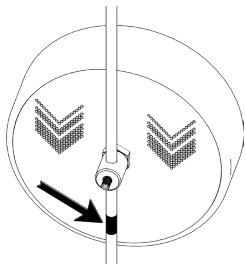

- 11 Adjust the shaft so that it is placed behind the body as seen in the image.

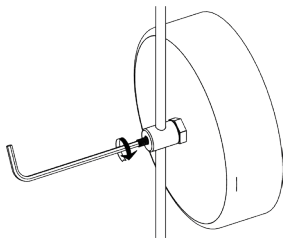

- 12 Once in place, fasten the shaft to the body using the screw and allen key.

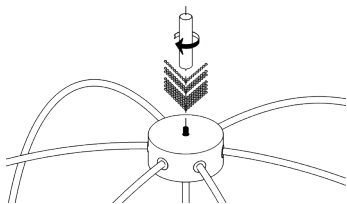

- 13 Use the connector cap to fasten the shaft in place from the top of the head connector.

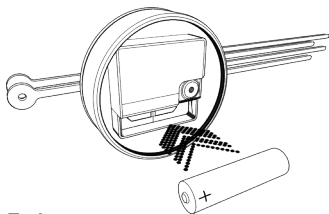

- 14 Insert battery

IMPORTANT

Before attaching the clock mechanism to the body, you will need align the minute hand directly in line with the hour hand (refer to the diagram). **DO NOT** manually turn the hour hand, ensure you only adjust the minute hand.

15

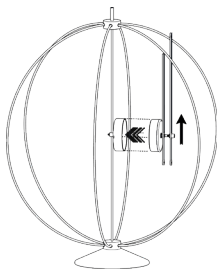

Once you have aligned the clock hands, place the mechanism onto the body with the hands facing 12:00.

Once the mechanism is attached to the body with hands pointing to 12:00, you may fix the time using **ONLY** the minute hand. Turn the minute hand manually until the desired time is set. The hour hand will move as you turn the minute hand.



USER'S GUIDE

- To clean your product, use a damp cloth. Do not use chemicals.
- **Remove the clock mechanism before cleaning.**
- To replace the battery, remove the mechanism from the body.
- After replacing the battery, bring the minute hand over the hour hand manually, then align the clock mechanism so that the hands are pointing to 12:00.
- 12:00 o'clock is where the hands should point when resetting your clock. Always **ONLY** turn the minute hand to adjust the time.
- If you require further information, please contact us.



Mclocks

More than
a clock

- 📍 +1 661 888-80-50
- 📱 @mclocks.store
- 🌐 www.mclocks.store
- ✉ info@mclocks.store