

# Bathroom

Architectural Designer Products

Harvey Norman



Adp



Hampton V-Groove 1500 Centre Bowl  
Matte White polyurethane cabinet finish  
Concrete Mist Cherry Pie Benchtop  
Pride Semi-Inset Basin (included)  
See page 8 for more details

# Contents

Introduction	4
Hampton Shaker	6
Hampton V-Groove	8
Hampton All-Drawer Shaker	10
Hampton All-Drawer V-Groove	12
Hampton Mini Shaker	14
Hampton Mini V-Groove	15
Hampton Shaving Cabinet Shaker	16
Hampton Shaving Cabinet V-Groove	17
Hampton Mirror	18
Hampton Tallboy Shaker	20
Hampton Tallboy V-Groove	21
Lexi	22
Hudson	24
Holly	26
Holly Ensuite	28
Billabong Mini	30
Embrace Mini	32
Handles	34
Cabinet & Benchtop Finishes	36
Product Specifications	48
Warranty, Care & Maintenance	57

# Proudly Australian Made



## DESIGNED & CRAFTED IN AUSTRALIA

Our factory, located just south of Sydney, is full of talented designers and craftsmen. This allows us to prototype and manufacture the latest in cabinet designs all under one roof.

## PERSONALISE YOUR VANITY

All of our cabinets are made to order which means you can personalise your vanity to suit any style.

**Adp**

www.adpaustralia.com.au  
@adpaustralia

## YOUR CHOICE, YOUR COLOUR

Choose from our wide variety of cabinet and benchtop colours, creating endless combinations for the style that's perfect just for you.

## CUSTOM SIZING

Can't see what you're looking for? We can custom make most of our products to your specifications, as everything is designed and manufactured in-house.

## HIGHEST QUALITY

Australian made products means quality you can trust.

# Hardware



**ADP pressed metal drawers** in fresh white with soft-close adapter. As seen on the Hampton and Holly Ensuite.



**ADP Premium soft-close drawers** in graphite. As seen on the Hampton Deluxe and Hampton All-Drawer.



**ADP Premium soft-close drawers** in white. As seen on the Hudson.



**ADP Deluxe soft-close drawers** with LED glass sides. As seen on the Holly and Lexi.



**Soft-close hinges** on all vanity, shaving cabinet and tallboy doors.



**3L Bin** stainless steel with keyhole fixing and push button lid. Included with the Lexi vanity.

# Universal Plug & Waste



Chrome Universal Plug & Waste included with all vanities. More colour options available at an additional charge.

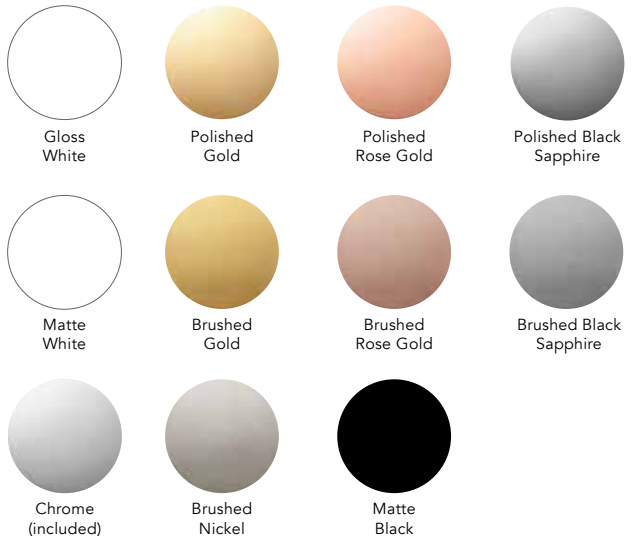



# Hampton Shaker

## Features

- Shaker cabinet fronts
- Wall hung only
- Door and drawer design
- Soft-close doors
- Complimentary 100mm splashback in matching benchtop colour

## Colour Options

- Matte White Polyurethane
- Matte Milton Moon Grey Polyurethane
- Matte Black Polyurethane

## 60mm Benchtop Options

- Cherry Pie Premium Solid Surface
- Friday Hybrid Quartz
- Caesarstone (additional charges apply)
- See page 42 for finishes

## Interior Options

- Hampton**  
Fresh white interior with ADP pressed metal drawers and soft-close adapter
- Hampton Deluxe**  
Premium graphite interior with ADP premium soft-close drawers

## Handle Options

- Aluminium recessed handle (white, silver or black)



Universal Plug & Waste included



Customisable



Australian Made

## Basin Options (included)

See page 54 for more details



Respect  
Gloss or Matte White



Dignity  
Gloss or Matte White

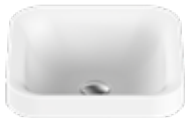

Truth  
Gloss or Matte White



Pride  
Gloss or Matte White

## Configurations

For codes and specifications see page 48

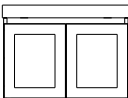

600 Centre Bowl  
2 Doors

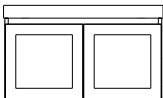

750 Offset Bowl  
1 Door, 1 Drawer

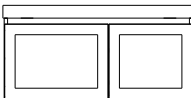

900 Centre Bowl  
1 Door, 1 Drawer

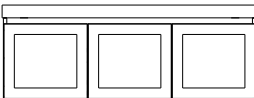

1200 Centre Bowl  
2 Doors, 1 Drawer

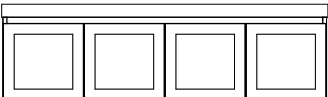

1500 Centre Bowl  
2 Doors, 2 Drawers

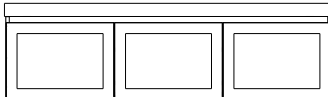

1500 Double Bowl  
2 Doors, 1 Drawer

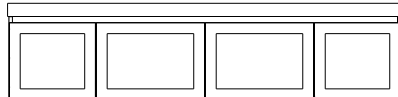

1800 Centre/Double Bowl  
2 Doors, 2 Drawers



Hampton Shaker 1200 Centre Bowl, pictured with splashback  
Matte White Polyurethane cabinet finish, Carrera Cherry Pie benchtop  
White Aluminium recessed handle



Dignity Semi-Inset Basin, Matte White (included)



Matte Black Polyurethane cabinet finish  
Bright White Cherry Pie benchtop



# Hampton V-Groove

## Features

- V-Groove cabinet fronts
- Wall hung only
- Door and drawer design
- Soft-close doors
- Complimentary 100mm splashback in matching benchtop colour

## Colour Options

- Matte White Polyurethane
- Matte Milton Moon Grey Polyurethane
- Matte Black Polyurethane

## 60mm Benchtop Options

- Cherry Pie Premium Solid Surface
- Friday Hybrid Quartz
- Caesarstone (additional charges apply)
- See page 42 for finishes

## Interior Options

- Hampton**  
Fresh white interior with ADP pressed metal drawers and soft-close adapter
- Hampton Deluxe**  
Premium graphite interior with ADP premium soft-close drawers

## Handle Options

- Aluminium recessed handle (white, silver or black)



Universal Plug & Waste included



Customisable



Australian Made

## Basin Options (included)

See page 54 for more details



Respect  
Gloss or Matte White



Dignity  
Gloss or Matte White

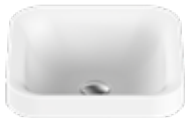

Truth  
Gloss or Matte White



Pride  
Gloss or Matte White

## Configurations

For codes and specifications see page 48

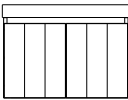

600 Centre Bowl  
2 Doors

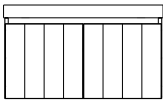

750 Offset Bowl  
1 Door, 1 Drawer

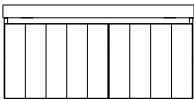

900 Centre Bowl  
1 Door, 1 Drawer

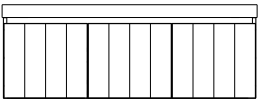

1200 Centre Bowl  
2 Doors, 1 Drawer

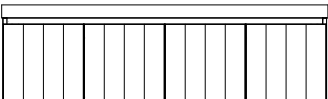

1500 Centre Bowl  
2 Doors, 2 Drawers



1500 Double Bowl  
2 Doors, 1 Drawer



1800 Centre/Double Bowl  
2 Doors, 2 Drawers



Hampton V-Groove 1500 Centre, pictured without splashback  
Matte White polyurethane cabinet finish  
Concrete Mist Cherry Pie Benchtop  
White Aluminium recessed handle

Pride Semi-Inset Basin (included)  
Hampton V-Groove Shaving Cabinets 300mm x 2  
Matte White polyurethane cabinet finish  
Hampton Mirror 900 with 600mm Chrome Daylight



Hampton V-Groove Deluxe 900, pictured without splashback  
Matte Milton Moon Grey polyurethane cabinet finish  
Bright White Cherry Pie benchtop



Dignity Semi-Inset Basin, Matte White (included)

# Hampton All-Drawer Shaker

### Features

Shaker cabinet fronts  
Wall hung only  
All-Drawer design  
Complimentary 100mm splashback in matching benchtop colour

### Colour Options

- Matte White Polyurethane
- Matte Milton Moon Grey Polyurethane
- Matte Black Polyurethane

### 60mm Benchtop Options

Cherry Pie Premium Solid Surface  
Friday Hybrid Quartz  
Caesarstone (additional charges apply)  
See page 42 for finishes

### Interior

Premium graphite interior with ADP premium soft-close drawers

### Handle Options

Aluminium recessed handle (white, silver or black)



Universal Plug & Waste included



Customisable



Australian Made

### Basin Options (included)

See page 54 for more details



Respect  
Gloss or Matte White



Dignity  
Gloss or Matte White



Truth  
Gloss or Matte White



Pride  
Gloss or Matte White

### Configurations

For codes and specifications see page 48

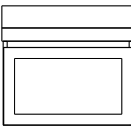

600 Centre Bowl

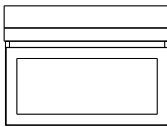

750 Centre Bowl

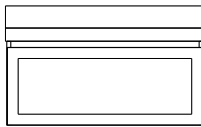

900 Centre Bowl

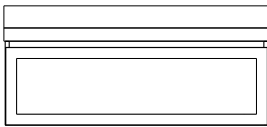

1200 Centre Bowl

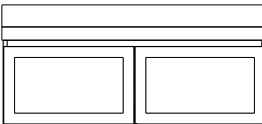

1200 Double Bowl

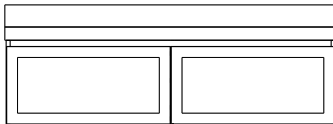

1500 Double Bowl

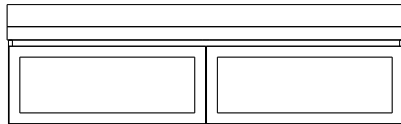

1800 Double Bowl



Hampton All-Drawer Shaker 1200 Centre Bowl, pictured with splashback Matte White Polyurethane cabinet finish, Carrera Cherry Pie benchtop White Aluminium recessed handle Dignity Semi-Inset Basin (included)

Hampton Shaker Shaving Cabinets 300mm x 2 Matte White polyurethane cabinet finish Hampton Mirror 600 with 300mm Chrome Daylight Hampton Shaker Tallboy



Premium soft-close drawers



Dignity Semi-Inset Basin, Matte White (included)

# Hampton All-Drawer V-Groove

## Features

V-Groove cabinet fronts  
Wall hung only  
All-Drawer design  
Complimentary 100mm splashback in matching benchtop colour

## Colour Options

- Matte White Polyurethane
- Matte Milton Moon Grey Polyurethane
- Matte Black Polyurethane

## 60mm Benchtop Options

Cherry Pie Premium Solid Surface  
Friday Hybrid Quartz  
Caesarstone (additional charges apply)  
See page 42 for finishes

## Interior

Premium graphite interior with ADP premium soft-close drawers

## Handle Options

Aluminium recessed handle (white, silver or black)



Universal Plug & Waste included



Customisable



Australian Made

## Basin Options (included)

See page 54 for more details



Respect  
Gloss or Matte White



Dignity  
Gloss or Matte White



Truth  
Gloss or Matte White



Pride  
Gloss or Matte White

## Configurations

For codes and specifications see page 48

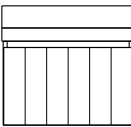

600 Centre Bowl

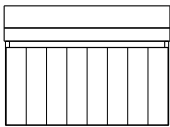

750 Centre Bowl



900 Centre Bowl

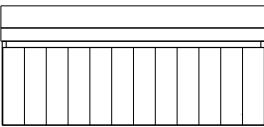

1200 Centre Bowl

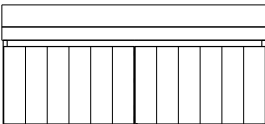

1200 Double Bowl

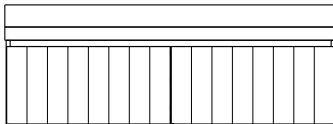

1500 Double Bowl

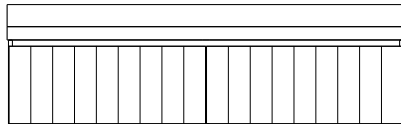

1800 Double Bowl

Hampton All-Drawer V-Groove 750 Centre Bowl, pictured with splashback  
Matte Black Polyurethane cabinet finish, Staccato Cherry Pie benchtop  
Black Aluminium recessed handle  
Respect Semi-Inset Basin, Matte White (included)  
Hampton V-Groove Tallboy, Matte Black Polyurethane cabinet finish





# Hampton Mini Shaker



Hampton Mini Shaker 600 Offset, pictured with splashback  
Matte White Polyurethane cabinet finish, Carrera Cherry Pie benchtop,  
White Aluminium recessed handle



Joy Basin, Matte White  
(included)

### Features

- Shaker cabinet fronts
- All-Door design, wall hung only
- Complimentary 100mm splashback in matching benchtop colour
- Fresh white or premium graphite interior and soft-close doors
- 900mm includes adjustable internal shelf (opposite basin)

### Basin (included)

See page 56 for more details



Joy  
Gloss or Matte White

### Configurations

For codes and specifications see page 49

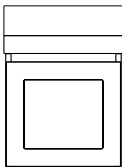

400 Centre Bowl  
1 Door

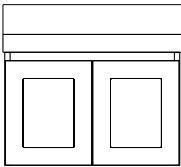

600 Offset Bowl  
2 Doors

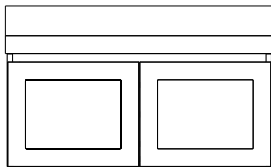

900 Offset Bowl  
2 Doors

### Colour Options

- Matte White Polyurethane
- Matte Milton Moon Grey Polyurethane
- Matte Black Polyurethane

### Handle Options

Aluminium recessed handle  
(white, silver or black)



### 60mm Benchtop Options

- Cherry Pie Premium Solid Surface
- Friday Hybrid Quartz
- Caesarstone (additional charges apply)
- See page 42 for finishes



Universal Plug &  
Waste included



Customisable



Australian  
Made

# Hampton Mini V-Groove



Hampton Mini V-Groove 900 Offset, pictured without splashback  
Matte White Polyurethane cabinet finish, Avalanche Cherry Pie  
benchtop, White Aluminium recessed handle



900mm includes adjustable internal shelf

### Features

- V-Groove cabinet fronts
- All-Door design, wall hung only
- Complimentary 100mm splashback in matching benchtop colour
- Fresh white or premium graphite interior and soft-close doors
- 900mm includes adjustable internal shelf (opposite basin)

### Basin (included)

See page 56 for more details



Joy  
Gloss or Matte White

### Configurations

For codes and specifications see page 49

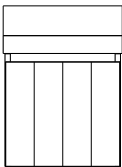

400 Centre Bowl  
1 Door

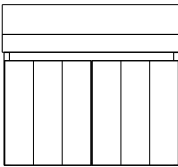

600 Offset Bowl  
2 Doors

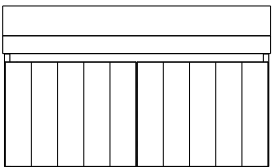

900 Offset Bowl  
2 Doors

### Colour Options

- Matte White Polyurethane
- Matte Milton Moon Grey Polyurethane
- Matte Black Polyurethane

### Handle Options

Aluminium recessed handle  
(white, silver or black)



### 60mm Benchtop Options

- Cherry Pie Premium Solid Surface
- Friday Hybrid Quartz
- Caesarstone (additional charges apply)
- See page 42 for finishes



Universal Plug &  
Waste included



Customisable



Australian  
Made

# Hampton Shaving Cabinet Shaker



## Features

- Shaker cabinet fronts
- Premium graphite or fresh white interior
- LED concealed lighting, 4000k
- Internal double power point
- Cord provision
- Internal magnified mirror (on mirrored door only, not available on 300 and 400mm)
- Soft-close doors
- Adjustable glass shelves
- Mirror is copper free

## Colour Options

- Matte White Polyurethane
- Matte Milton Moon Grey Polyurethane
- Matte Black Polyurethane



Australian Made



Customisable

## Configurations

For codes and specifications see page 49

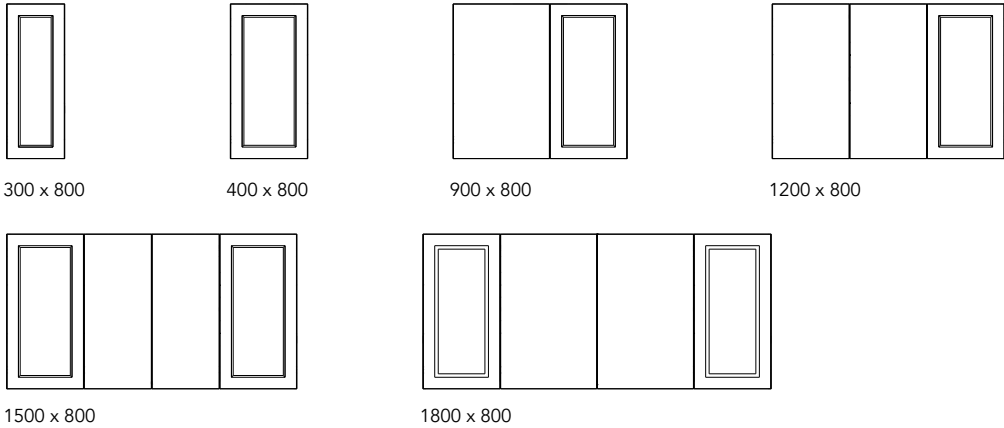

# Hampton Shaving Cabinet V-Groove



## Features

- V-Groove cabinet fronts
- Premium graphite or fresh white interior
- LED concealed lighting, 4000k
- Internal double power point
- Cord provision
- Internal magnified mirror (on mirrored door only, not available on 300 and 400mm)
- Soft-close doors
- Adjustable glass shelves
- Mirror is copper free

## Colour Options

- Matte White Polyurethane
- Matte Milton Moon Grey Polyurethane
- Matte Black Polyurethane



Australian Made



Customisable

## Configurations

For codes and specifications see page 49

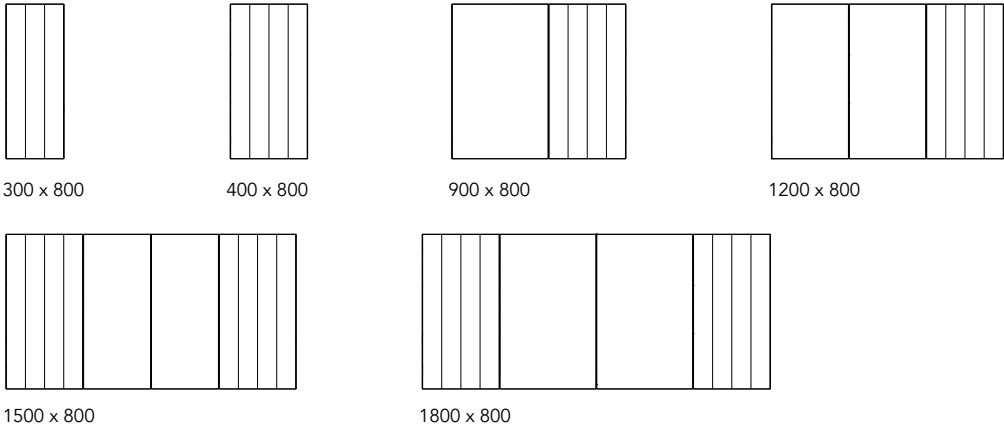

# Hampton Mirror



## Features

Polished edge mirror mounted on 16mm black, grey or white satin board  
Overhead Daylight light included, Chrome or Matte Black  
Can be installed vertically or horizontally  
Copper free mirror



## Colour Options

-  Polar White Silk (Matte)
-  Grey Nouveau Silk (Matte)
-  Black Silk (Matte)

## Daylight Overhead Light (included)

Chrome or Matte Black



## Configurations

For codes and specifications see page 49

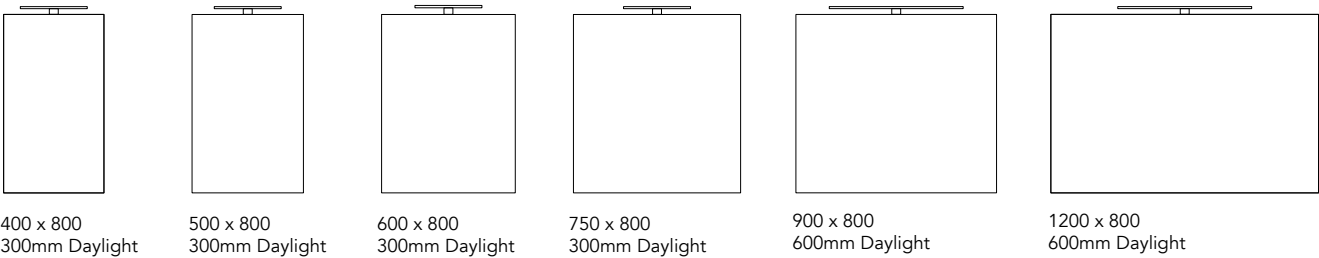

Hampton Mirror  
900mm

*Get the  
Look*

Hampton Shaving  
Cabinet 300mm x 2



# Hampton Tallboy Shaker



Hampton Tallboy Shaker  
Matte White Polyurethane cabinet finish  
White Aluminium Recessed Handle



Internal copper free mirror

Features

- Shaker cabinet fronts
- Wall Hung
- Premium graphite or fresh white interior
- Adjustable internal shelves
- Soft-close doors, optional left or right hand hinged
- Aluminium recessed handle available in white, silver or black
- Internal copper free mirror on top door with full swing hinges

Colour Options

- Matte White Polyurethane
- Matte Milton Moon Grey Polyurethane
- Matte Black Polyurethane



Australian Made

Configuration

For codes and specifications see page 49

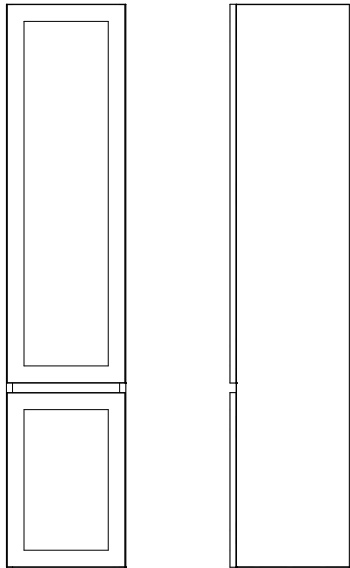

Front ViewEnd View

# Hampton Tallboy V-Groove



Hampton Tallboy V-Groove  
Matte Black Polyurethane cabinet finish  
Black Aluminium Recessed Handle

Features

- V-Groove cabinet fronts
- Wall Hung
- Premium graphite or fresh white interior
- Adjustable internal shelves
- Soft-close doors, optional left or right hand hinged
- Aluminium recessed handle available in white, silver or black
- Internal copper free mirror on top door with full swing hinges

Colour Options

- Matte White Polyurethane
- Matte Milton Moon Grey Polyurethane
- Matte Black Polyurethane



Australian Made

Configuration

For codes and specifications see page 49

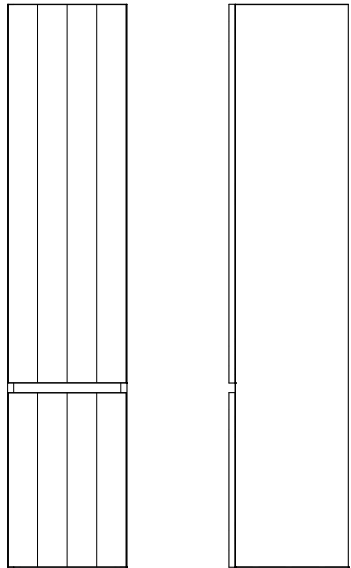

Front ViewEnd View

# Lexi

### Features

Wall Hung and Floor Mount

304 grade stainless steel frame, fabricated in Australia and finished in Matte Black or Matte White powdercoat

ADP Deluxe soft-close drawers in Graphite with LED illuminated glass sides

Premium graphite interior, soft-close doors

### Handle Options



**Point Knobs**  
Brushed Nickel, Matte Black, Brushed Brass

### Cabinet Finish Options

Woodgrain

Polyurethane

See page 36 for finishes

### Metal Frame Finish Options

Matte Black powdercoat

Matte White powdercoat



### 20mm Benchtop Options

Cherry Pie Premium Solid Surface

Friday Hybrid Quartz

Caesarstone (additional charges apply)

See page 42 for finishes



Universal Plug & Waste included



3L Bin included



Australian Made



**Reign Knobs**  
Brushed Nickel, Matte Black, Brushed Brass



**Loop Leather Pull**  
Black or Tan

### Margot Basin (Included)

For codes and specifications see page 56



Matte or Gloss White



Matte Black



Matte White Inside,  
Matte Black Outside



Matte Black Inside,  
Matte White Outside



Matte White Inside,  
Matte Grey Outside



Matte White Inside,  
Matte Pink Outside

### Configurations - Wall Hung

For codes and specifications see page 50

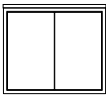

600 Centre Bowl

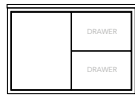

750 Centre/Offset Bowl

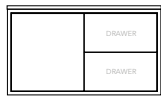

900 Centre/Offset Bowl

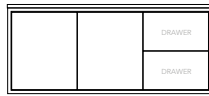

1200 Centre/Offset Bowl

### Configurations - Floor Mount

For codes and specifications see page 50

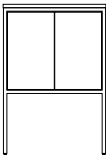

600 Centre Bowl

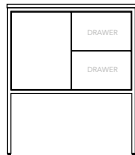

750 Centre/Offset Bowl

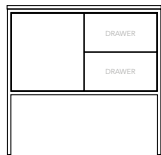

900 Centre/Offset Bowl

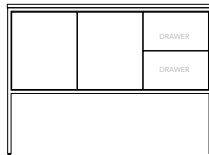

1200 Centre/Offset Bowl



Lexi 750 Wall Hung Centre Bowl  
Angora Oak Woodmatt Cabinet finish, Bright White Cherry Pie benchtop  
Matte Black Point Knobs  
Margot Basin, Matte White (included)



Margot Basin, Matte White (included)



Lexi 750 Floor Mount  
Angora Oak Woodmatt Cabinet finish  
Bright White Cherry Pie benchtop  
Loop Leather Pulls, Tan

# Hudson

### Features

- All-Drawer design
- Wall Hung only
- Fresh White interior
- ADP Premium soft-close drawers in white
- Bevel-grip finger pull



Universal Plug & Waste included



Australian Made

### Configurations

For codes and specifications see page 51

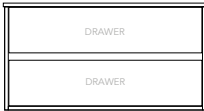

900 Offset Bowl



1200 Offset Bowl



1500 Offset/Double Bowl

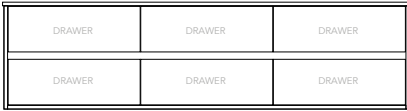

1800 Offset/Double Bowl

### Cabinet Finish Options

- Woodgrain only
- See page 36 for finishes

### Top

- Matte White Solid Surface moulded top
- Tap hole options - 1 tap hole (10 o'clock or 2 o'clock), or 0 tap hole



Hudson 1500 Double Bowl  
Angora Oak Woodmatt Cabinet finish



Solid Surface top



Hudson 900 Left Offset Bowl  
Prime Oak Woodmatt Cabinet finish



# Holly

Features

- All-Drawer design
- Wall Hung and Floor Mount
- Bevelled frame
- Premium graphite interior
- ADP Deluxe soft-close drawers in graphite with LED illuminated glass sides

Top

- Gloss White Ceramic moulded top
- Integrated Overflow

Cabinet Finish Options

- Woodgrain
- Polyurethane
- See page 36 for finishes



Universal Plug & Waste included



LED Drawers



Australian Made

Handle Options

- Bevel-grip finger pull
- Handles (see page 34)

Configurations - Wall Hung

For codes and specifications see page 51

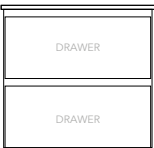

600 Centre Bowl

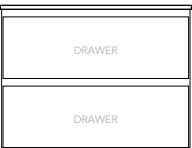

750 Centre Bowl

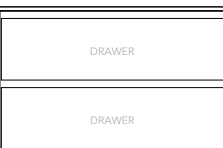

900 Centre Bowl

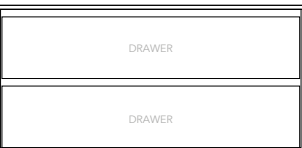

1200 Centre/Double Bowl

Configurations - Floor Mount

For codes and specifications see page 52

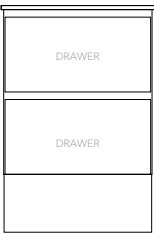

600 Centre Bowl

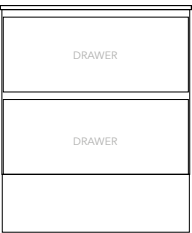

750 Centre Bowl

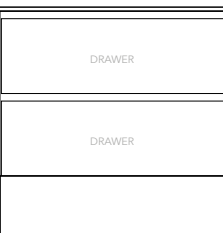

900 Centre Bowl

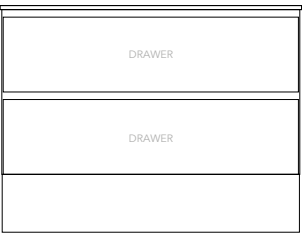

1200 Centre/Double Bowl



Holly 1200 Wall Hung Centre Bowl  
Fox Teakwood Chalk Cabinet finish



All-Drawer design, bevel-grip finger pull



Ceramic top with overflow

# Holly Ensuite

## Features

Door & Drawer design  
Wall Hung and Floor Mount  
Fresh white interior  
ADP pressed metal drawers with soft-close adapter

## Top

Gloss White Ceramic moulded top  
Integrated Overflow  
360mm depth

## Configurations - Wall Hung

For codes and specifications see page 52

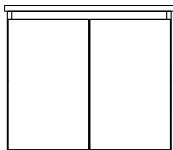

600 Centre Bowl

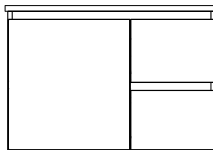

750 Centre Bowl

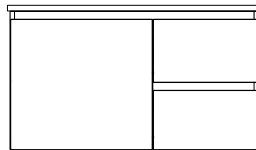

900 Centre Bowl

## Configurations - Floor Mount

For codes and specifications see page 52

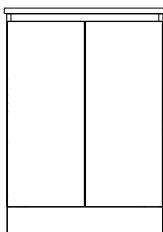

600 Centre Bowl

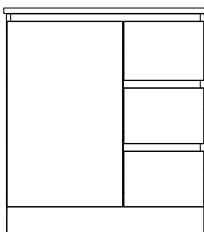

750 Centre Bowl

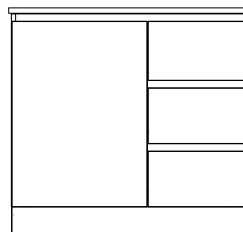

900 Centre Bowl

## Cabinet Finish Options

Woodgrain  
Polyurethane  
See page 36 for finishes



Universal Plug &  
Waste included



Australian  
Made

## Handle Options

Bevel-grip finger pull  
Handles (see page 34)



Holly Ensuite 750 Wall Hung Centre Bowl  
Tasmanian Oak Woodmatt Cabinet finish



Ceramic top with overflow



ADP pressed metal drawers in  
white with soft-close adapter

# Billabong Mini

## Features

- All-Door design
- Wall Hung and Floor Mount
- Soft-close door, left or right hand hinged
- Exposed interior

## Top

- Matte White Solid Surface
- Reversible
- 1 tap hole only

## Configurations

For codes and specifications see page 53

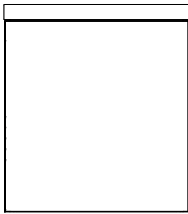

Wall Hung

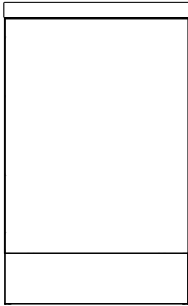

Floor Mount

## Designed to suit the Space Saver Plumbing Kit

Please note, due to the narrow depth of this basin, care should be taken when purchasing plumbing fittings or bottle traps. We recommend using the Space Saver Plumbing Kit (SPCSVRKIT40).



## Cabinet Finish Options

- Woodgrain
- Polyurethane
- See page 36 for finishes

## Handle

- Side bevel-grip finger pull



Universal Plug & Waste included



Australian Made



Billabong Mini Wall Hung  
Bottega Oak Woodmatt Cabinet finish



Exposed interior



Matte White solid surface top, reversible



# Embrace Mini

Features

- All-Door design
- Wall Hung only
- Exposed ends
- Soft-close door, left or right hand hinged
- Premium graphite interior

Top

- Gloss White Cast Marble
- Reversible
- 1 tap hole only

Configuration

For codes and specifications see page 53

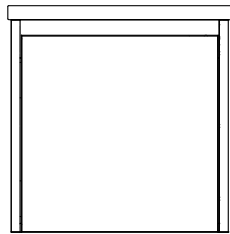

Wall Hung

Cabinet Finish Options

- Woodgrain
- Polyurethane
- See page 36 for finishes

Handle

- Bevel-grip finger pull



Universal Plug & Waste included



Australian Made



Embrace Mini  
Natural Oak Ravine Cabinet finish



Soft-close door



Gloss White cast marble top

Please note, due to the narrow depth of this basin, care should be taken when purchasing plumbing fittings or bottle traps.

# Handles

Add any handle from the below range at no extra cost to applicable vanities.



## FLAT-D HANDLES

Available in Chrome.  
Projection: 28mm



## LINK HANDLES

Available in Chrome.  
Projection: 30mm



## PLUS HANDLES

Available in Chrome.  
Projection: 25mm



## SYDNEY HANDLES

Available in Chrome.  
Projection: 28mm



## ORBIT HANDLES

Available in Chrome, Matte Black,  
Matte White.  
Projection: 34mm



## ROUND CROSS BAR HANDLES

Available in Chrome, Brushed Nickel,  
Matte Black, Polished Rose Gold.  
Projection: 33mm



## SEASHELL HANDLES

Available in Brushed Nickel, Chrome,  
Matte Black and Brushed Brass  
Projection: 23mm



## MADISON KNOBS

Available in White, Chrome, Black.  
Projection: 30mm



## PLAIN KNOBS

Available in Brushed Nickel, Matte Black.  
Projection: 30mm

# Premium Handles

A surcharge applies for Premium Handles, please enquire in store for pricing.



## BLAZE 60MM HANDLES

Available in Brushed Nickel,  
Brushed Matte Black, Brushed Brass.  
Projection: 21mm



## BLAZE 350MM HANDLES

Available in Brushed Nickel,  
Brushed Matte Black, Brushed Brass.  
Projection: 21mm



## BRIDGE HANDLES

Available in Brushed Nickel, Matte Black,  
Brushed Brass.  
Projection: 30mm  
Hole centres: 160mm



## FLUTED HANDLES

Available in Brushed Nickel,  
Matte Black, Brushed Brass.  
Projection: 27mm  
Hole centres: 128mm



## FRINGE HANDLES

Available in Brushed Nickel,  
Matte Black, Brushed Brass.  
Projection: 30mm  
Hole centres: 160mm



## HAMMER HANDLES

Available in Chrome, Brushed Nickel,  
Matte Black, Brushed Brass.  
Projection: 25mm  
Hole centres: 32mm



## REIGN HANDLES

Available in Brushed Nickel, Matte Black,  
Brushed Brass.  
Projection: 33mm  
Hole centres: 160mm



## REIGN KNOBS

Available in Brushed Nickel, Matte Black,  
Brushed Brass.  
Projection: 33mm



## POINT KNOBS

Available in Brushed Nickel, Matte Black,  
Brushed Brass.  
Projection: 25mm  
Hole centres: 16mm



## LOOP LEATHER PULL

Available in Black or Tan.  
Length: 70mm



# Cabinet Finishes



FOX TEAKWOOD CHALK (TEXTURED)



MILTON MOON GREY POLYURETHANE (MATTE ONLY)

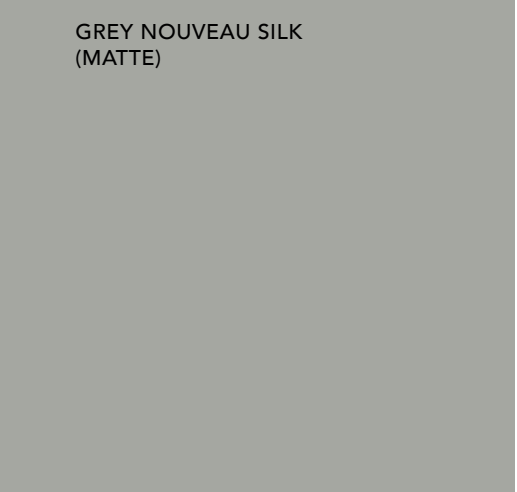

GREY NOUVEAU SILK (MATTE)

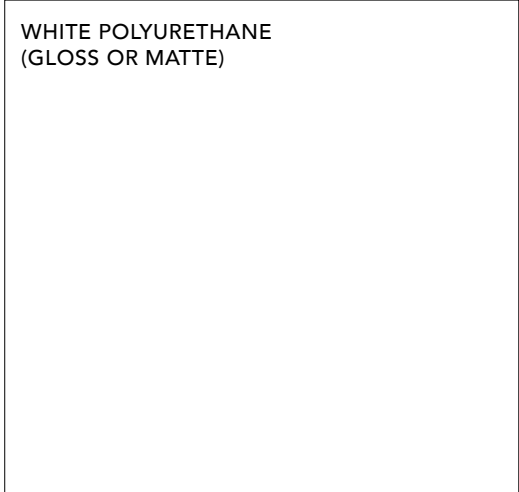

WHITE POLYURETHANE (GLOSS OR MATTE)

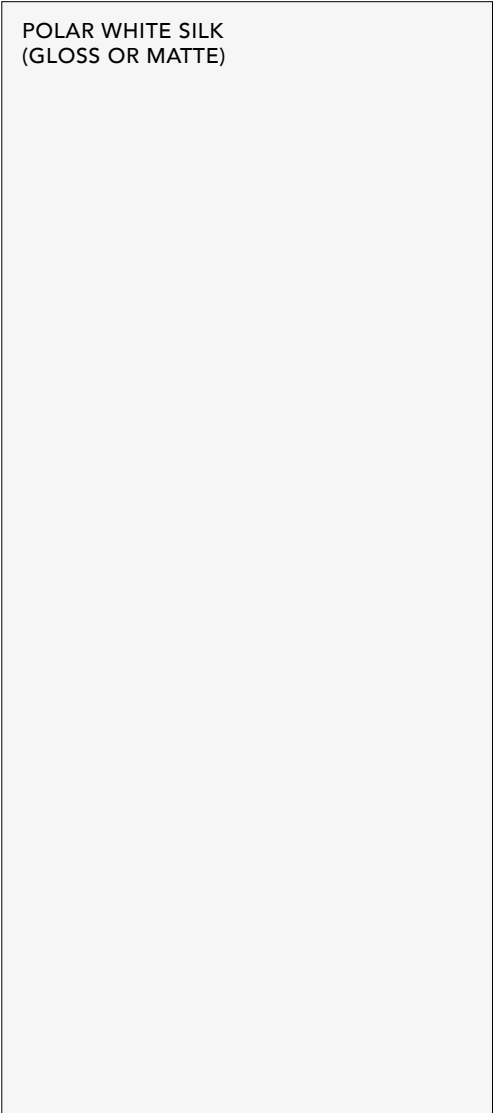

POLAR WHITE SILK (GLOSS OR MATTE)



CONCRETE FORMWOOD CHALK (TEXTURED)



CHALKY TEAK NUANCE (TEXTURED)



DELANA OAK CHALK (TEXTURED)

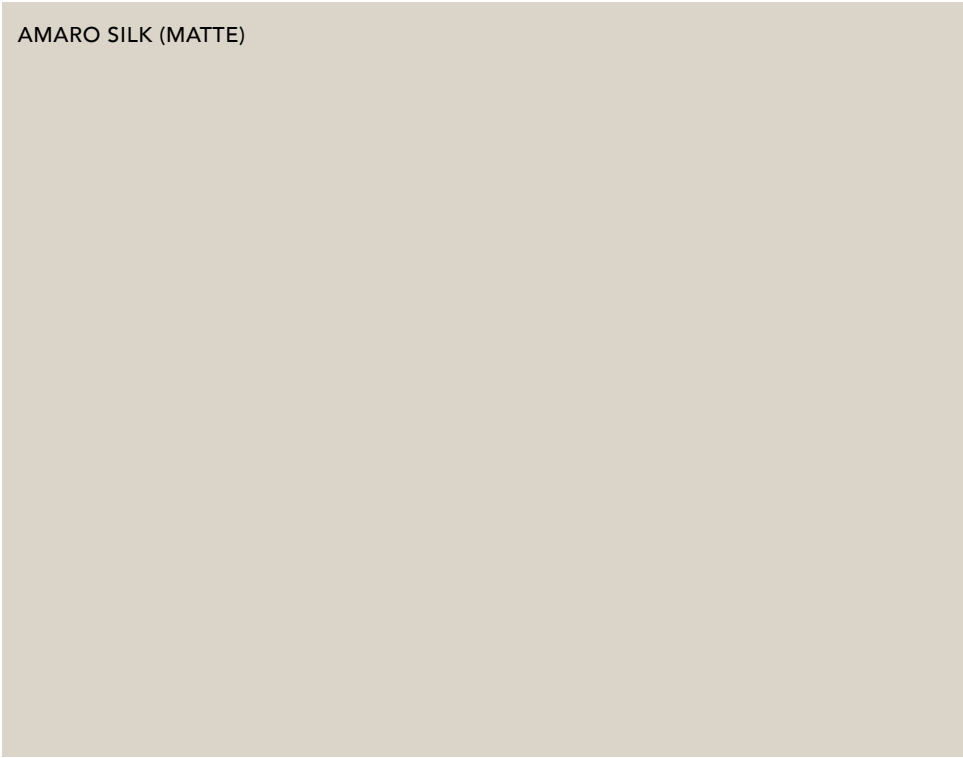

AMARO SILK (MATTE)



WHITE PAINTED WOOD NATURAL (MATTE)

Due to limitations in the printing process the colours in this brochure are a guide only. We recommend basing your selection on a physical colour sample, to see colour samples please visit a bathroom retailer. Go to [www.adpaustralia.com.au/stockists](http://www.adpaustralia.com.au/stockists) to find a stockist near you.



# Cabinet Finishes

NATURAL OAK RAVINE (TEXTURED)

SEASONED OAK CHALK (TEXTURED)

GESSO LINI SILK (GLOSS)

ANGORA OAK WOODMATT (TEXTURED)

COASTAL OAK WOODMATT (TEXTURED)

SUBLIME TEAK CHALK (TEXTURED)

RURAL OAK CHALK (TEXTURED)

RAW BIRCH PLY NATURAL (MATTE)

TASMANIAN OAK WOODMATT (TEXTURED)

ELEGANT OAK CHALK (TEXTURED)

PRIME OAK WOODMATT (TEXTURED)

BOSTON OAK WOODMATT (TEXTURED)

Due to limitations in the printing process the colours in this brochure are a guide only. We recommend basing your selection on a physical colour sample, to see colour samples please visit a bathroom retailer. Go to [www.adpaustralia.com.au/stockists](http://www.adpaustralia.com.au/stockists) to find a stockist near you.



# Cabinet Finishes

ROJO WALNUT WOODMATT (TEXTURED)

AGED WALNUT CHALK (TEXTURED)

NOTAIO WALNUT RAVINE (TEXTURED)

ANTICO OAK WOODMATT (TEXTURED)

ROCCO LINI SILK (GLOSS)

TRUFFLE LINI SILK (GLOSS)

BOTTEGA OAK WOODMATT (TEXTURED)

BLACK NUANCE (TEXTURED)

BLACK POLYURETHANE (MATTE ONLY)

BLACK SILK (MATTE)

PERUGIAN WALNUT WOODMATT (TEXTURED)

Due to limitations in the printing process the colours in this brochure are a guide only. We recommend basing your selection on a physical colour sample, to see colour samples please visit a bathroom retailer. Go to [www.adpaustralia.com.au/stockists](http://www.adpaustralia.com.au/stockists) to find a stockist near you.



# Benchtop Finishes

Cherry Pie Premium Solid Surface

COPPER TERRAZZO

JASMINE

CALACATTA

ICE WHIP

AVALANCHE

FROST

cherry pie

PREMIUM SOLID SURFACE

- Manufactured using acrylic resin solid surface material.
- Developed to withstand heat, chemicals, moisture, and impact.
- Resists stains better than natural stone surfaces.
- Cherry Pie is non-porous, hygienic, easy to clean, maintain, and repair.
- Does not require sealing or treating.

*Variations in the finish are to be expected.*

*Cherry Pie is free of crystalline silica.*

SUGAR CREAM

CONCRETE MIST

STACCATO

CARRERA

BRIGHT WHITE

Due to limitations in the printing process the colours in this brochure are a guide only. We recommend basing your selection on a physical colour sample, to see colour samples please visit a bathroom retailer. Go to [www.adpaustralia.com.au/stockists](http://www.adpaustralia.com.au/stockists) to find a stockist near you.



# Benchtop Finishes

Friday Hybrid Quartz™

EXCITE

BOARD WALK

WHITE WASH

## Friday Hybrid Quartz™

- Friday™ is made from 93% quartz and 7% polymer resin.
- Has the look and feel of granite but provides a much more consistent and solid colour.
- High performance, durable, stain resistant, and scratch resistant.
- Has exceptional strength and toughness, is difficult to chip, crack or dull.
- Friday™ is non-porous, hygienic, easy to clean and maintain.

*Friday Hybrid Quartz™ is made from a natural quartz product, variations in the finish are to be expected.*

FRIDAY NIGHT

Due to limitations in the printing process the colours in this brochure are a guide only. We recommend basing your selection on a physical colour sample, to see colour samples please visit a bathroom retailer. Go to [www.adpaustralia.com.au/stockists](http://www.adpaustralia.com.au/stockists) to find a stockist near you.



Concrete Mist Cherry Pie benchtop  
Pride Basin, Matte White



# Benchtop Finishes

## Caesarstone®

ORGANIC WHITE

FROSTY CARRINA

CLOUDBURST CONCRETE

ALPINE MIST

WHITE ATTICA

OCEAN FOAM

INTENSE WHITE

PURE WHITE

NOBLE GREY

RUGGED CONCRETE

OYSTER

JET BLACK



*Caesarstone® incurs a 25% surcharge.*

- Created from up to 93% natural quartz aggregates, organic pigments and enhanced polymer resins.
- Caesarstone® provides a surface with exceptional properties of heat, stain, scratch and chip resistance.
- Caesarstone® is one of Australia's most recognised brands of quartz surfaces.
- Selection of 12 colours available at regular manufacturing time (see below). Additional colours on request subject to availability. Expect extended manufacturing time of up to 4-6 weeks. (Excludes Supernatural Ultra finishes).

*Caesarstone® is made from a natural quartz product, variations in the finish are to be expected.*

Due to limitations in the printing process the colours in this brochure are a guide only. We recommend basing your selection on a physical colour sample, to see colour samples please visit a bathroom retailer. Go to [www.adpaustralia.com.au/stockists](http://www.adpaustralia.com.au/stockists) to find a stockist near you.



# Product Specifications

## Hampton\*

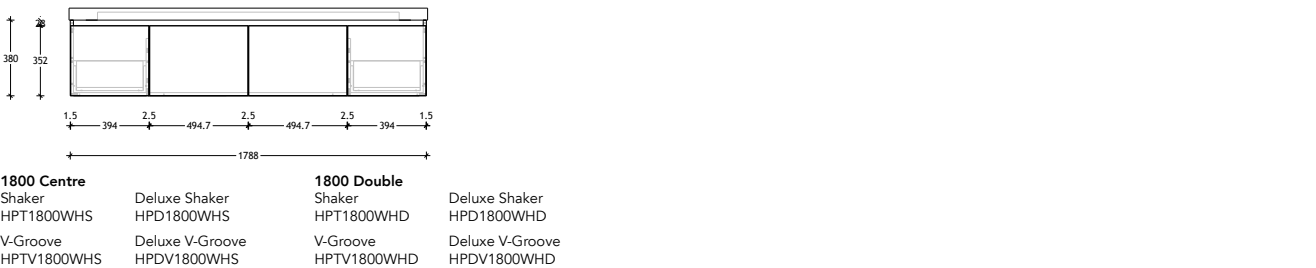
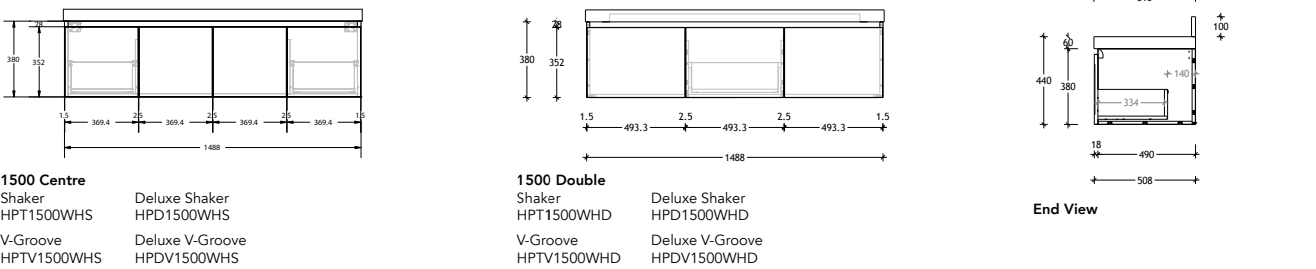
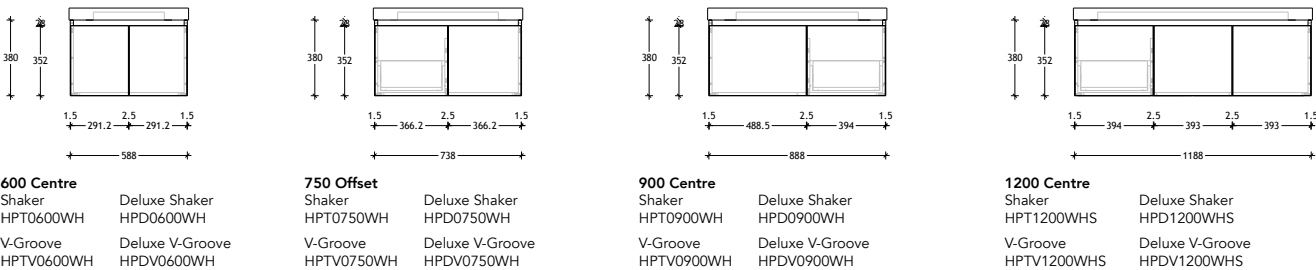

## Hampton All-Drawer\*

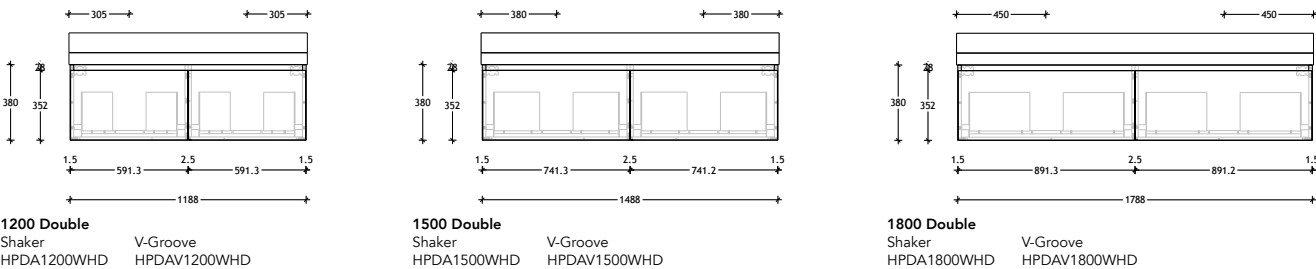
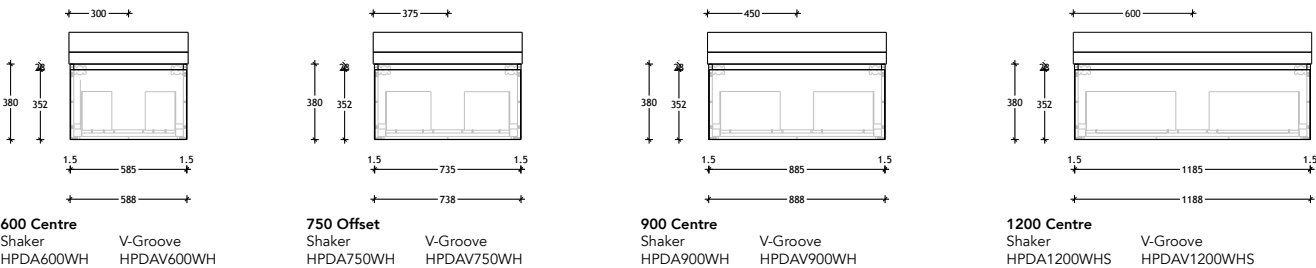

End View

## Hampton Mini\*

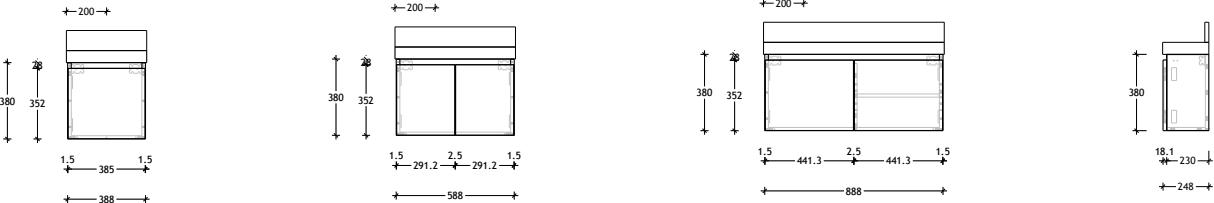

End View

## Hampton Shaving Cabinet

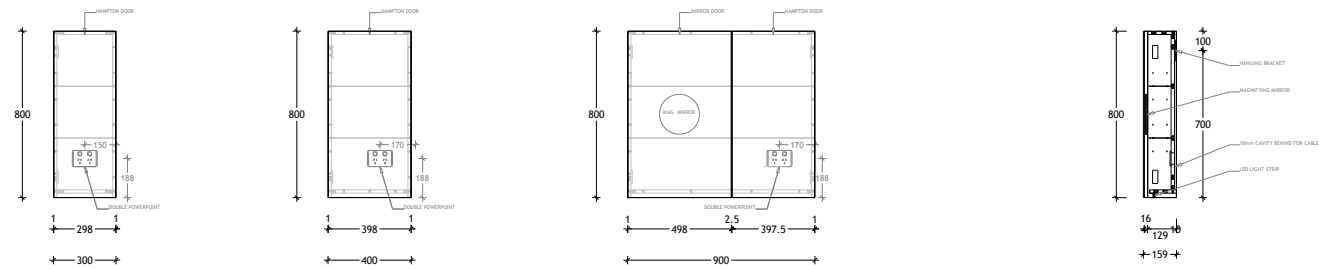

End View

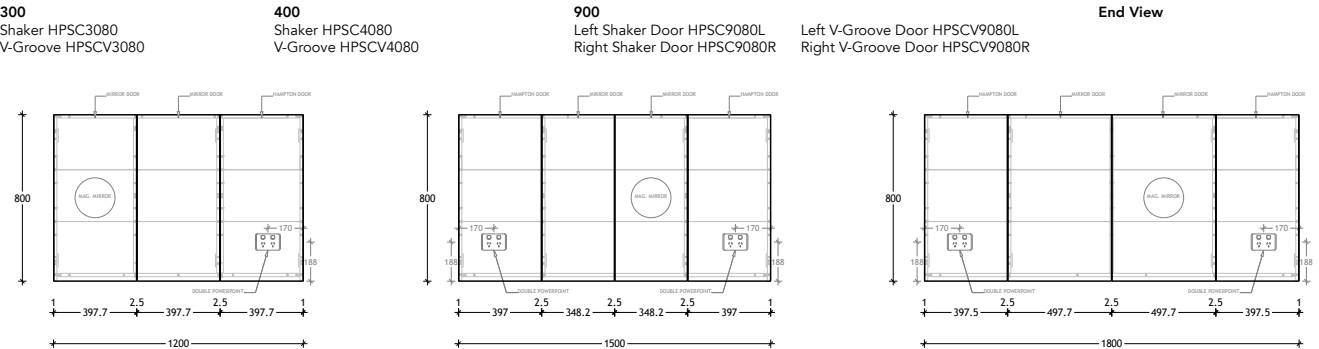

## Hampton Mirror

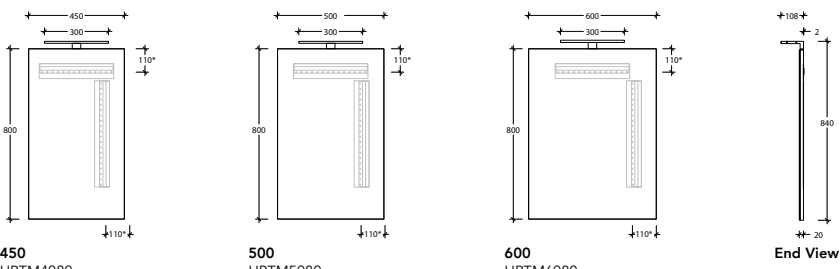

End View

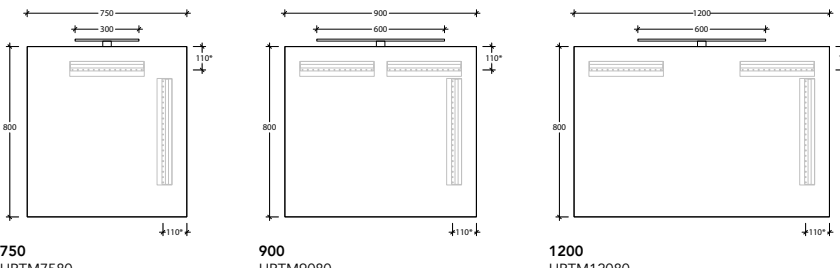

## Hampton Tallboy

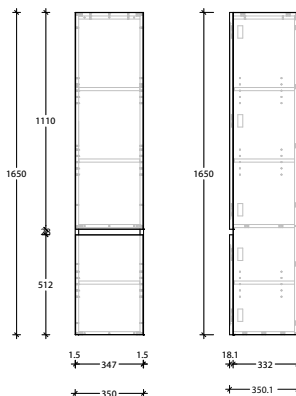

Hampton Tallboy  
Shaker HPTB1650WH  
V-Groove HPTBV1650WH

\*For benchtop options please add the following to end of product code: CP = Cherry Pie, F = Friday Hybrid Quartz, CS = Caesarstone  
Do not drill or rough in until you have received and measured your product as variations to final measurments can be expected. Specifications are correct as of 04/2021.

\*For benchtop options please add the following to end of product code: CP = Cherry Pie, F = Friday Hybrid Quartz, CS = Caesarstone  
Do not drill or rough in until you have received and measured your product as variations to final measurments can be expected. Specifications are correct as of 04/2021.



# Product Specifications

## Lexi Wall Hung\*

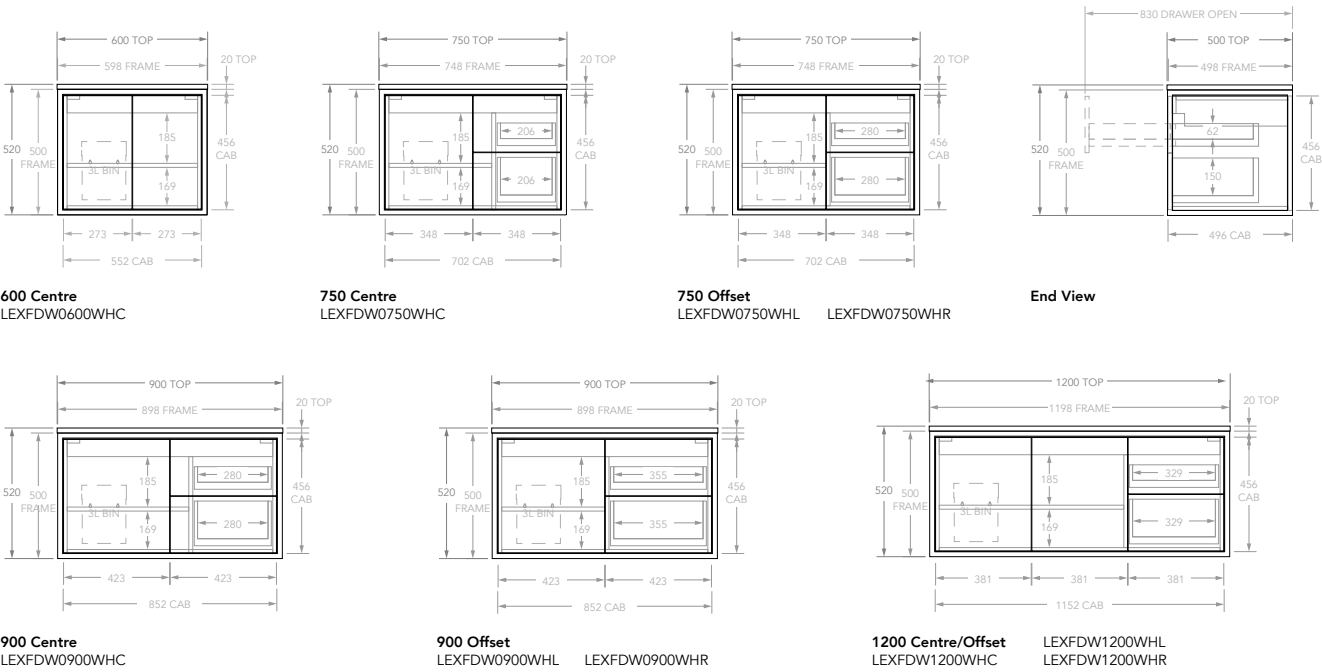

## Lexi Floor Mount\*

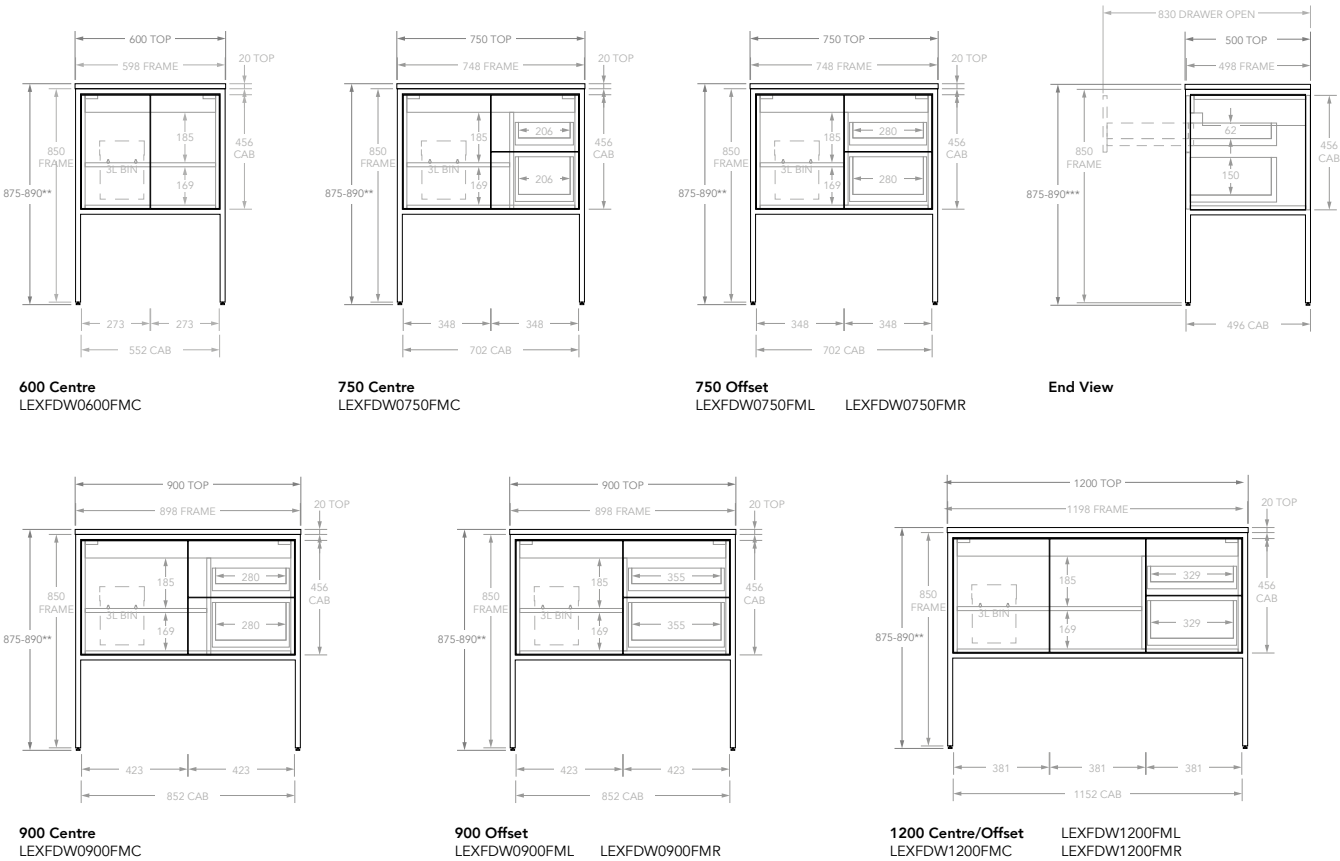

## Hudson

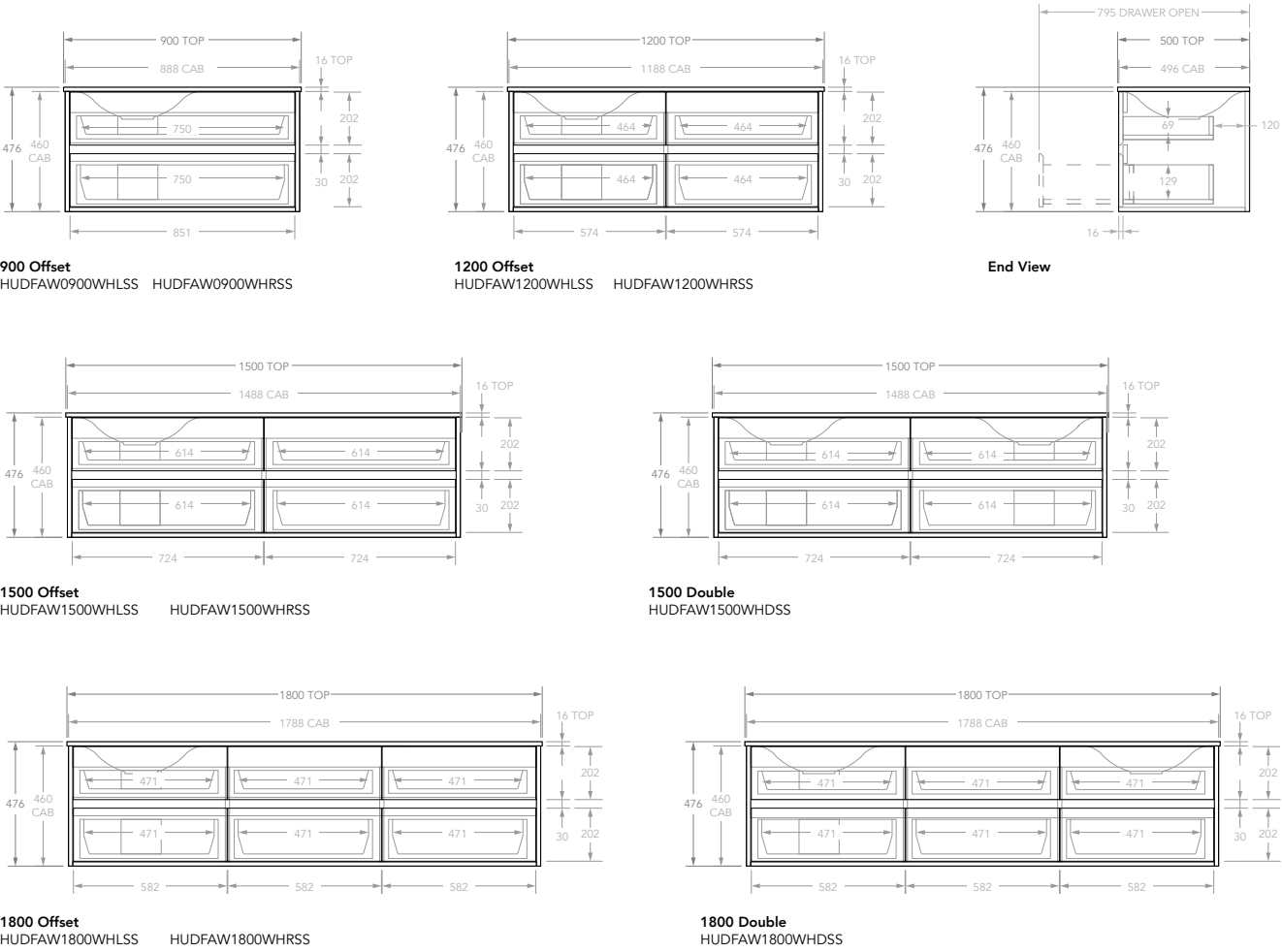

## Holly Wall Hung

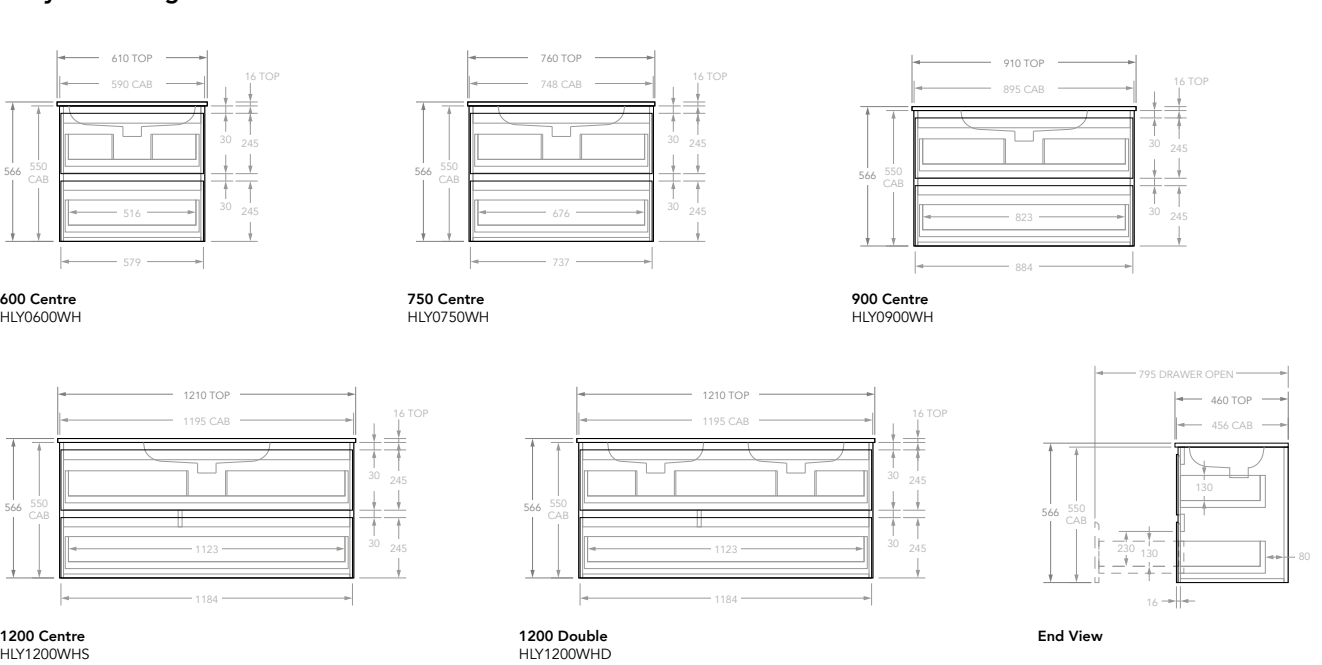

\*For benchtop options please add the following to end of product code: CP = Cherry Pie, F = Friday Hybrid Quartz, B = Bamboo, CS = Caesarstone  
Do not drill or rough in until you have received and measured your product as variations to final measurments can be expected. Specifications are correct as of 04/2021.

\*For benchtop options please add the following to end of product code: CP = Cherry Pie, F = Friday Hybrid Quartz, B = Bamboo, CS = Caesarstone  
Do not drill or rough in until you have received and measured your product as variations to final measurments can be expected. Specifications are correct as of 04/2021.

# Product Specifications

## Holly Floor Mount

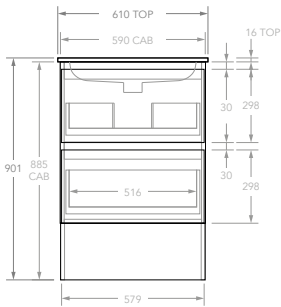

600 Centre  
HLY0600WK

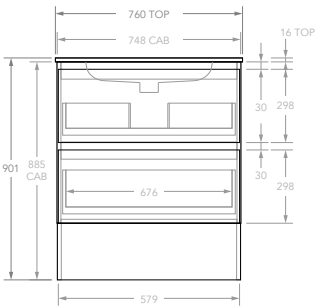

750 Centre  
HLY0750WK

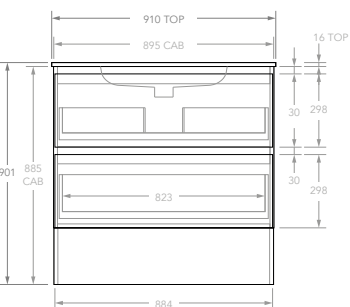

900 Centre  
HLY0900WK

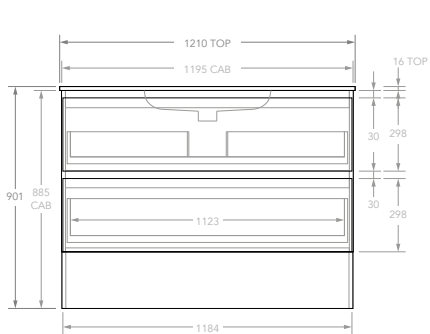

1200 Centre  
HLY1200WKS

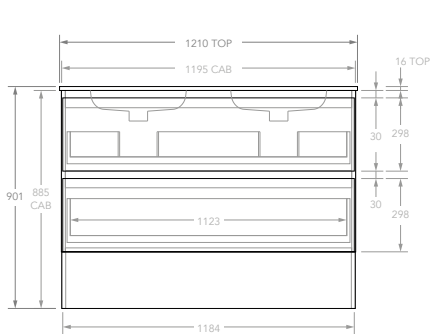

1200 Double  
HLY1200WKD

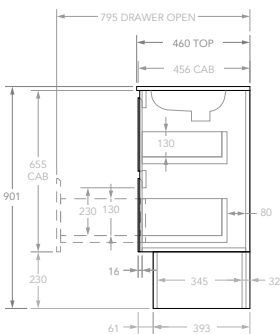

End View

## Holly Ensuite Wall Hung

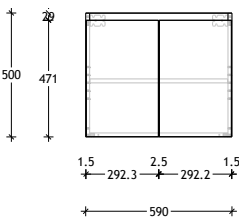

600 Centre  
HLYE600WH

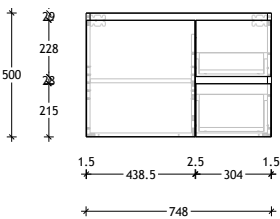

750 Centre  
HLYE750WH

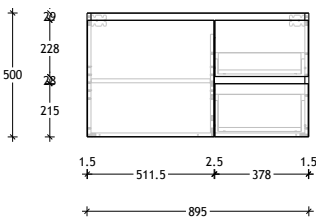

900 Centre  
HLYE900WH

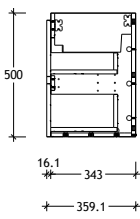

End View

## Holly Ensuite Floor Mount

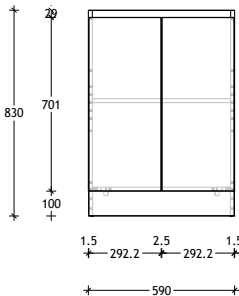

600 Centre  
HLYE600WK

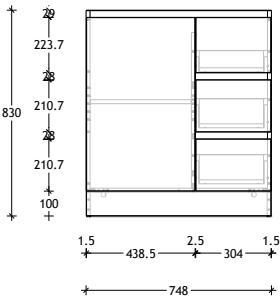

750 Centre  
HLYE750WK

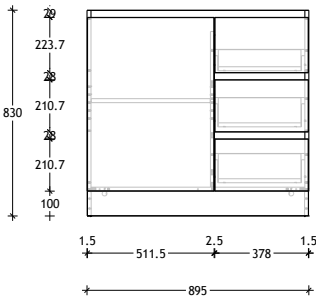

900 Centre  
HLYE900WK

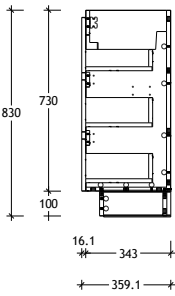

End View

## Embrace Mini

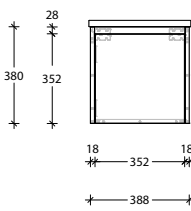

EMBM0400WH

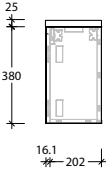

End View

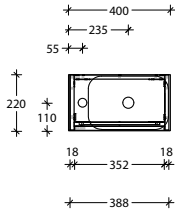

Top View

## Billabong Mini

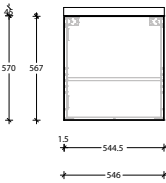

Wall Hung  
BILLM0550WH

End View

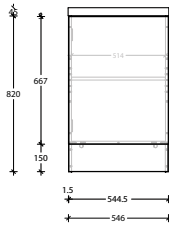

Floor Mount  
BILLM0550WK

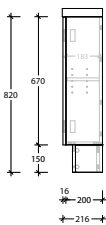

End View

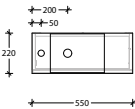

Top View

# Basin Specifications

## Respect

**Features**

- Semi-Inset
- Solid Surface
- 6L Capacity
- No overflow
- Suits a 32mm waste

**Finishes**

- Matte White  
TOPTRES400-TS
- Gloss White  
TOPTRES400-G

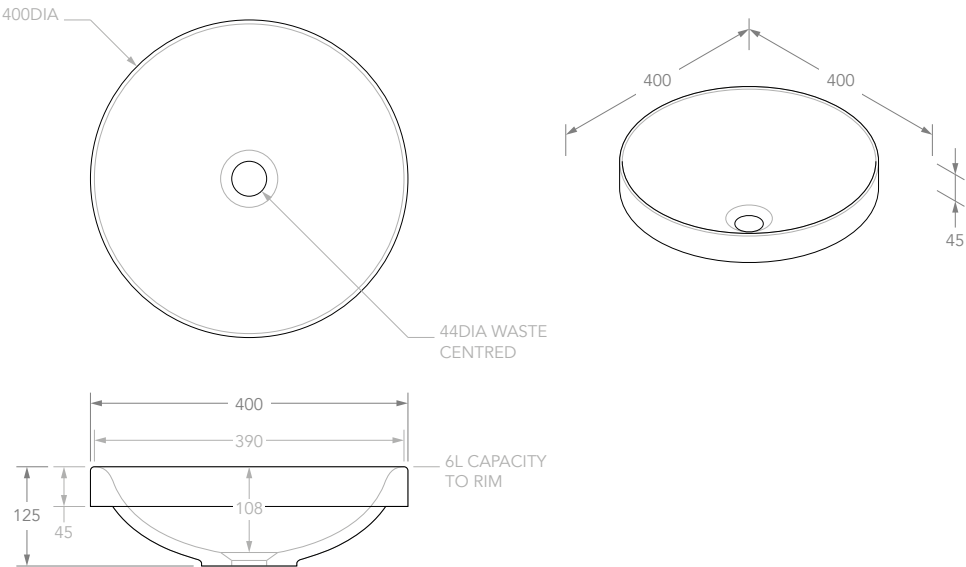

## Dignity

**Features**

- Semi-Inset
- Solid Surface
- 7L Capacity
- No overflow
- Suits a 32mm waste

**Finishes**

- Matte White  
TOPTDIG5037-TS
- Gloss White  
TOPTDIG5037-G

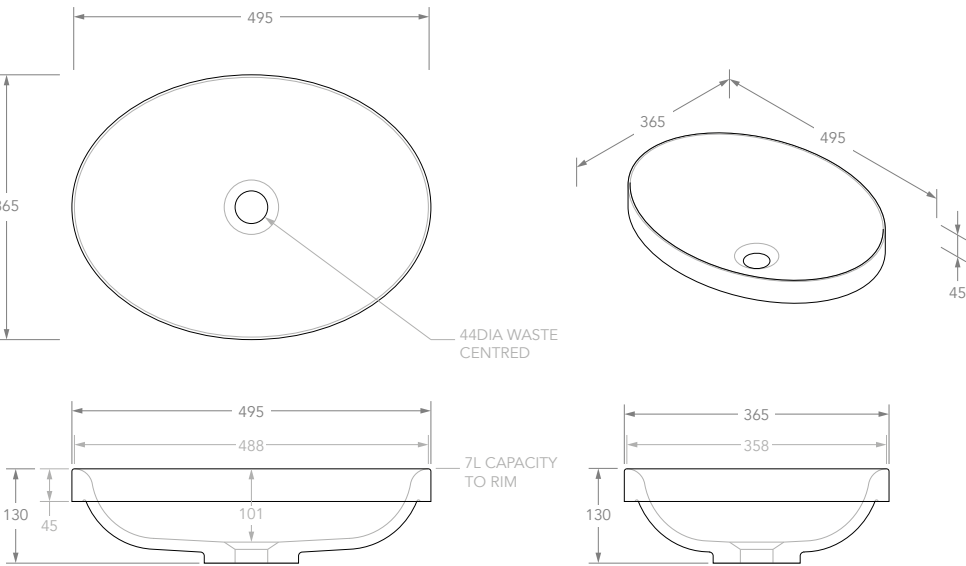

## Truth

**Features**

- Semi-Inset
- Solid Surface
- 5L Capacity
- No overflow
- Suits a 32mm waste

**Finishes**

- Matte White  
TOPTTRU3737-TS
- Gloss White  
TOPTTRU3737-G

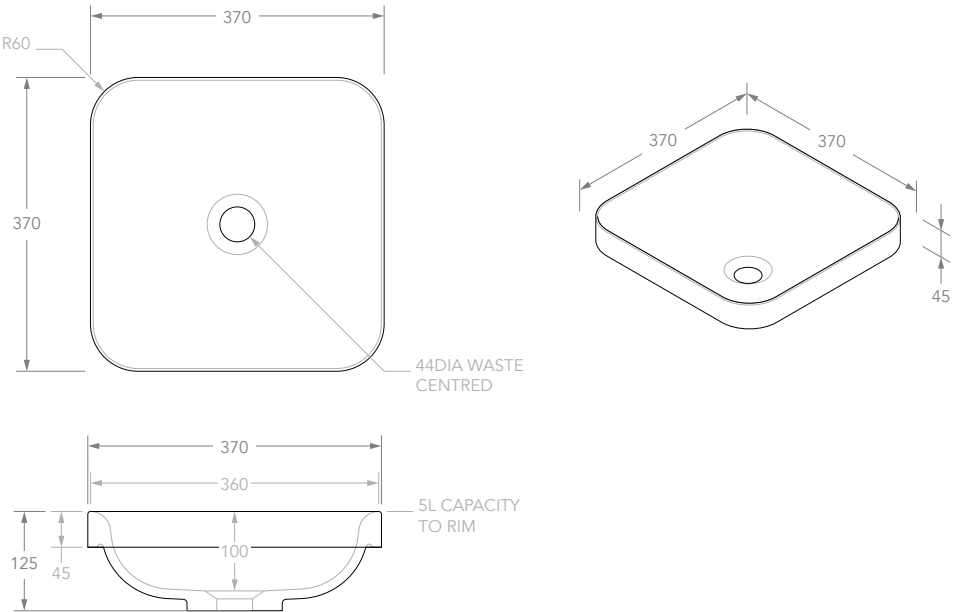

## Pride

**Features**

- Semi-Inset
- Solid Surface
- 9L Capacity
- No overflow
- Suits a 32mm waste

**Finishes**

- Matte White  
TOPTPRI5537-TS
- Gloss White  
TOPTPRI5537-G

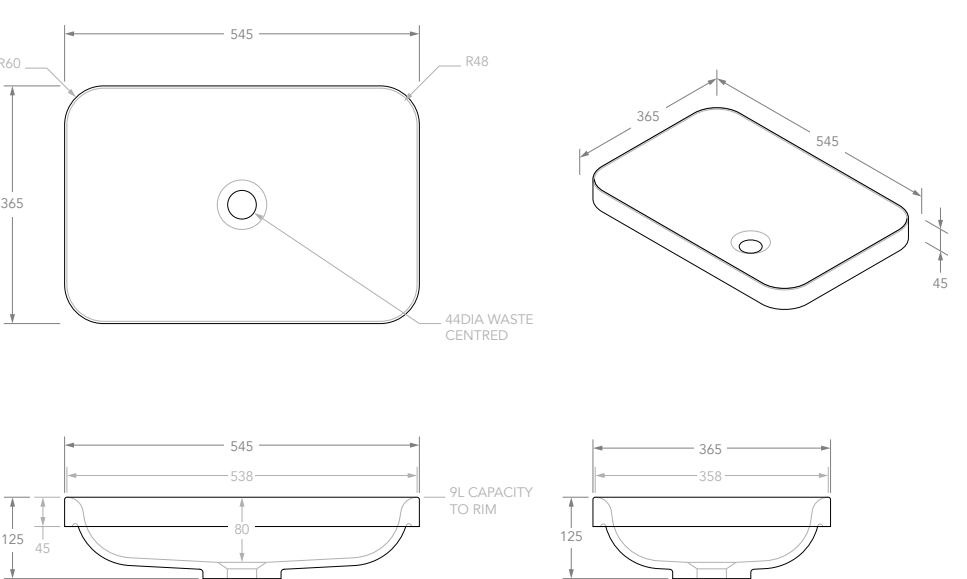



# Basin Specifications

## Margot

### Features

Above-Counter  
Ceramic  
9L Capacity  
No overflow  
Suits a 32mm waste

### Finishes

Matte White TOPCMAR360MW	Matte White Outside/ Matte Black Inside TOPCMAR360WB
Gloss White TOPCMAR360GW	Matte Grey Outside/ Matte White Inside TOPCMAR360DGW
Matte Black TOPCMAR360MB	
Matte Black Outside/ Matte White Inside TOPCMAR360BW	Matte Pink Outside/ Matte White Inside TOPCMAR360DPW

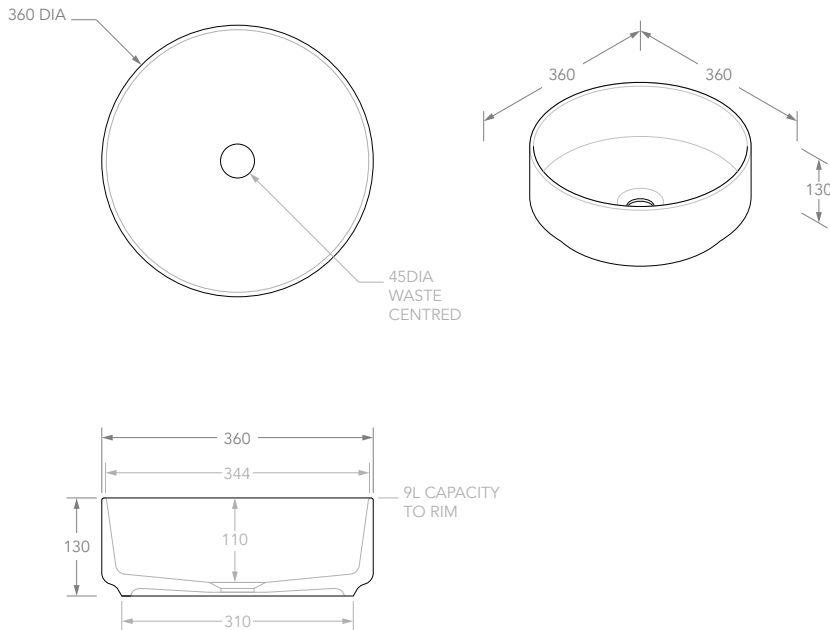

## Joy

### Features

Semi-Inset  
Solid Surface  
3L Capacity  
No overflow  
Suits a 32mm waste

### Finishes

Matte White  
TOPSJOY2819WM  
Gloss White  
TOPSJOY2819WG

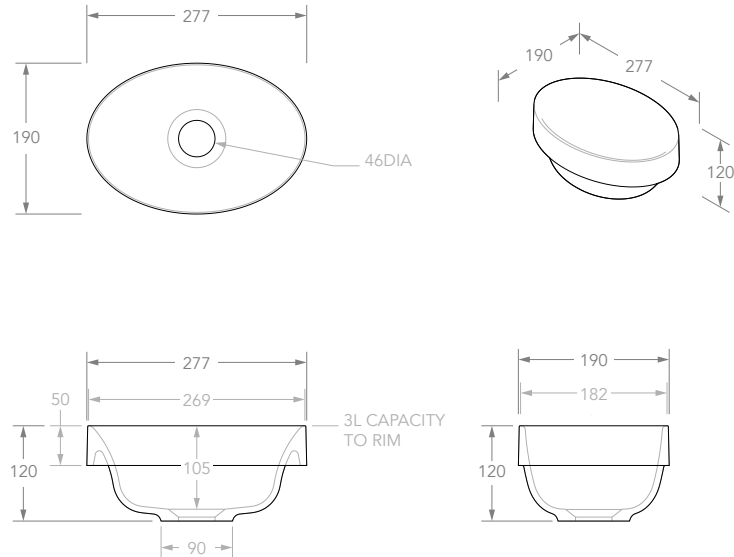

## WARRANTY

**NOTE:** Unless otherwise stated warranties for ADP products are as follows:

PRODUCT	DOMESTIC WARRANTY	COMMERCIAL WARRANTY
Cabinets - Vanities, Tallboys & Ensembles, Shaving Cabinets (excluding mirror)	10 years	1 year
Cherry Pie / Friday Hybrid Quartz / Caesarstone benchtops	10 years	1 year
Acrylic Tops / Cast Marble Tops / Solid Surface Tops	7 years	1 year
Ceramic Moulded Tops	5 years	1 year
Solid Surface Basins	7 years	1 year
Ceramic Basins	1 year	1 year
Baths	7 years	1 year
Mirrors (including mirrored surfaces on cabinets)	1 year	1 year
Hardware	7 years	1 year
Electrical / Lighting / Plumbing Fittings	1 year	1 year
Tapware		
Cartridge	15 years	1 year
Body (against manufacturing faults and flaking)	7 years	1 year
Martini Ritz body (against faults and flaking)	1 year	1 year
Parts and Labour	2 years	1 year
Bathroom Accessories	7 years	1 year

Our products come with guarantees that cannot be excluded under the Australian Consumer Law. You are entitled to a replacement or refund for a major failure upon inspection by an authorised representative where a product is found to be defective in construction, material or assembly. You are also entitled to have the goods repaired or replaced if the goods fail to be of acceptable quality and the failure does not amount to a major failure, free of charge.

### CONDITIONS

- Items must be installed by a licensed tradesperson.
- Failure is due to a fault in the manufacture of the product.
- Proof of purchase is provided.
- The installation of the product is in accordance with the instructions provided.

### EXCLUSIONS

To the fullest extent permitted by law, the manufacturer excludes all liability for damage or injury to any person, damage to any property and any indirect consequential or other loss or damage. Manufacturer will not be liable for the cost of installation or removal of any unit and the warranty will be VOIDED if damage occurred during or after INSTALLATION or a damaged or incorrect unit has been installed. Door and drawer adjustment; Unsuitable or improper use; Incorrect installation or installation not in accordance with the instructions provided; Installation or part installation by the purchaser or any person other than a LICENSED tradesperson; Normal wear and tear; Inadequate or complete lack of maintenance; chemical, electrochemical or electrical influences; excessive heat damage or Harsh detergents or abrasive cleaners used on product finishes, are NOT considered a warranty issue. Acrylic, Ceramic, Solid Surface and Bamboo basins and tops have a maximum water temperature of 65°C, Cast Marble has a maximum water temperature of 70°C, water temperatures above this will void warranty.

### CLAIM PROCEDURE

For all warranty queries customers are to contact the branch where the product was purchased. These details can be found on your purchase invoice.

### AN IMPORTANT NOTE ON BATHROOM VENTILATION

Good ventilation will save you thousands of dollars and keep your family healthy - mould can be a huge problem in bathrooms if they're not properly ventilated. Moisture can be the root of all wet area products breaking down and failing, in particular your vanity and mirror. These products are usually water resistant not waterproof so it's important moisture does not build up which will mean your products will last longer, saving you money. Good ventilation is also key to achieve lower humidity in the room which will minimise bacteria growth and prevent mould and mildew. You'll have less mildew on your grout, walls and ceilings, and fewer mould spores to threaten your respiratory health.

Signs of poor ventilation include black spotting on mirrors, paint starting to flake on the ceiling, bubbling of paint coatings on fixtures, and furniture swelling. Evidence of mould or mildew is also a good indicator that your ventilation is not adequate.

The best sign that your ventilation is sufficient is that the mirror doesn't steam up and the tiled walls aren't wet. The best way to achieve this is to have a good exhaust fan that is correctly sized for the space, to do this you need approximately 50 cfm per toilet and 50cfm per shower or bath. Run the fan every time water is being used in the bathroom and run it for around 15 minutes after you shower. If you have a bathroom window, opening that daily (even in the chilly winter months) in addition to using the exhaust fan will help to keep your bathroom fresh and mould-free.





## CARE & MAINTENANCE

If you cannot identify basin, top or cabinet material of your product, contact your merchant or see product information at [www.adpaustralia.com.au](http://www.adpaustralia.com.au).

### TIPS

- ADP products are produced from materials that are well suited to the bathroom, however it is important that your bathroom has sufficient ventilation to avoid excessive moisture. High humidity will lead to permanent dampness and mould, resulting in deterioration of the materials.
- Care must always be taken to dry any excessive moisture or water spillage.

### CABINETS

- To maintain the finish on your cabinet use only a soft cloth and weak solution of non abrasive detergent.
- To remove scratches, marks, etc. on two pack polyurethane, rub gently with car cutting compound, car polish or household brass/silver cleaner.
- Goods used in construction are water/moisture-resistant, but not water-proof.
- All cabinets should be installed at least 300mm away from showers or bathtubs to avoid water damage.

### CAST MARBLE & ACRYLIC

- To maintain the finish on your Cast Marble or Acrylic top use only a soft cloth and weak solution of non-abrasive detergent.
- To remove scratches, marks, etc. rub gently with car cutting compound, car polish or household brass/silver cleaner.
- Cast Marble basins and tops have a maximum water temperature of 70°C, to avoid thermal shock - heat damage or crazing.
- Acrylic tops have a maximum water temperature of 65°C, to avoid thermal shock - heat damage or crazing.

### CERAMIC BASINS AND TOPS

- To maintain the finish on your ceramic top use only a soft cloth and weak solution of non abrasive detergent.
- Due to the glazed surface of ceramic tops, scratches cannot be repaired or removed.
- Due to ceramic being a handcrafted product that is fired at high temperatures, some visual distortion may occur. This is not a defect but can be seen to add to the beauty of the product.
- Ceramic basins and tops have a maximum water temperature of 65°C, to avoid thermal shock - heat damage or crazing.

### SOLID SURFACE / CHERRY PIE / FRIDAY HYBRID QUARTZ / CAESARSTONE

- Wipe clean with a soft damp cloth or sponge.
- For basic stains clean with mild detergents. For **gloss and semi-gloss** surfaces you can use a non abrasive polish or Brasso. For **matte** surface use a scourer pad or scotch bright to maintain the matte finish.
- Cherry Pie, Friday Hybrid Quartz™ and Caesarstone® benchtops have excellent heat and chemical resistant properties compared to other surfacing products, however to preserve the surface and protect against damage from heat, do not place hot items directly on the surface. Even though Cherry Pie, Friday™ and Caesarstone® can withstand high temperatures, prolonged periods or extreme heat can cause permanent damage.
- Solid Surface basins and tops have a maximum water temperature of 65°C, to avoid thermal shock - heat damage or crazing.

### MIRRORS

**FOR BEST RESULTS** - use a slightly moistened microfibre cloth to remove dry dirt or grime, then buff clean with dry microfibre cloth or use a soft dry cloth with a tight weave (which is more soft and non-abrasive). This will leave you with a clean, smear-free finish. By using alkaline (ammonia) or acid (vinegar) based products you not only risk damaging the silvered backing of the mirror, but also tend to leave behind streaks and smears.

**DO NOT** use ammonia-based cleaning products such as glass cleaner. These may erode the mirror's silver backing. Be sure to read the label of any such cleaning products before use.

**PROTECTION AGAINST 'BLACK-SPOTTING'** - Alkaline, acid and moisture elements can cause the silvered backing of a mirror to darken, this is usually referred to as 'black-spotting'. An easy way to protect your mirror against black-spotting is to regularly oil any exposed edges (i.e. polished or bevelled edges), using non-petroleum based oils (eg. sewing machine oil). This will act as a seal to protect against such elements. Always remember to keep your mirror dry and wipe off any water, moisture or steam.

Hudson 900 Left Offset Bowl  
Prime Oak Woodmatt Cabinet finish



# VANITIES BASINS MIRRORS + MORE

## Store Locations

Harvey Norman Auburn  
Harvey Norman Balgowlah  
Harvey Norman Bundall  
Harvey Norman Cairns  
Harvey Norman Campbelltown  
Harvey Norman Caringbah  
Harvey Norman Castle Hill  
Harvey Norman Erina  
Harvey Norman Fyshwick  
Harvey Norman Gordon  
Harvey Norman Hornsby  
Harvey Norman Liverpool  
Harvey Norman Newcastle  
Harvey Norman Penrith  
Harvey Norman Punchbowl  
Harvey Norman Warrawong  
Harvey Norman at Domayne Alexandria  
Harvey Norman at Domayne Auburn



**A** Architectural  
Designer  
Products

   @adpaustalia

[www.adpaustalia.com.au](http://www.adpaustalia.com.au)



Due to limitations in the printing process the colours in this brochure are a guide only. The manufacturer/distributor reserves the right to vary specifications or delete models from their range without prior notification. All measurements within this brochure are nominal and are subject to change. The manufacturer/distributor take no responsibility for printing errors. Specifications correct at time of printing 05/2021. Please visit [www.adpaustalia.com.au](http://www.adpaustalia.com.au) for most current technical information.

