

# Tail. Assist

INSTALLATION INSTRUCTIONS NISSAN NP300 SLOW DOWN EASY UP STRUTS  
PART NUMBER: **NP12**



# Tail. Assist

INSTALLATION INSTRUCTIONS NISSAN NP300 SLOW DOWN EASY UP STRUTS  
PART NUMBER: **NP12**



2 x Straps



1 x Up Strut



2 x Inner plates



1 x Down strut

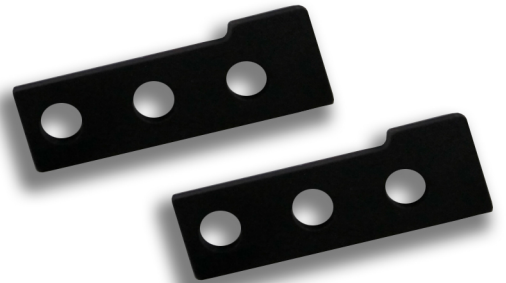

2 x Outer brackets.



6 x mounting bolts

# Tail. Assist

INSTALLATION INSTRUCTIONS NISSAN NP300 SLOW DOWN EASY UP STRUTS  
PART NUMBER: **NP12**

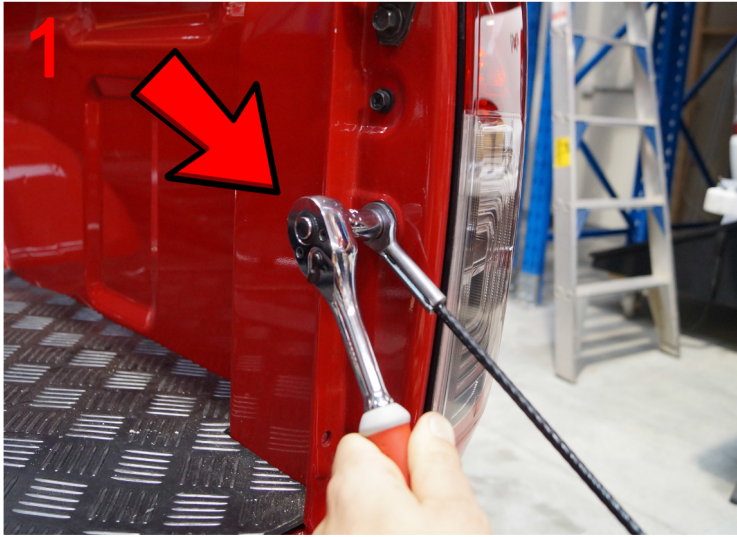

1: Remove cable bolt from the tub



2: Remove strap bolt from the tailgate



3: Bolt on the drilling template as pictured



4: Mark the three holes as pictured



5: Drill the three holes to 10mm  
TIP: drill smaller holes first to help locate the bit

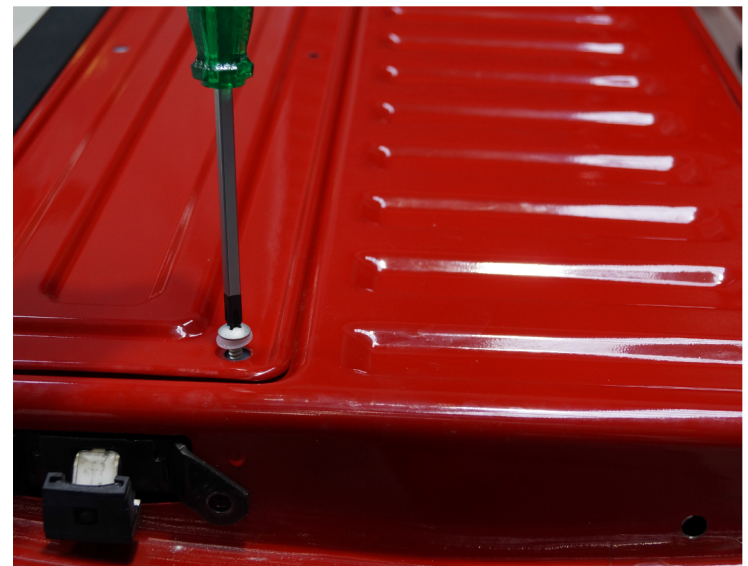

6: Remove the tailgate access panel

## INSTALLATION INSTRUCTIONS NISSAN NP300 SLOW DOWN EASY UP STRUTS PART NUMBER: **NP12**

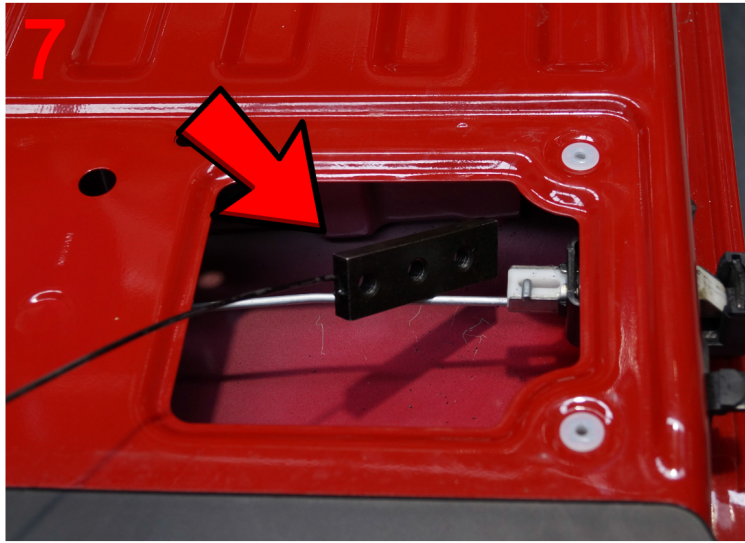

7: Place the backing plate inside the tailgate

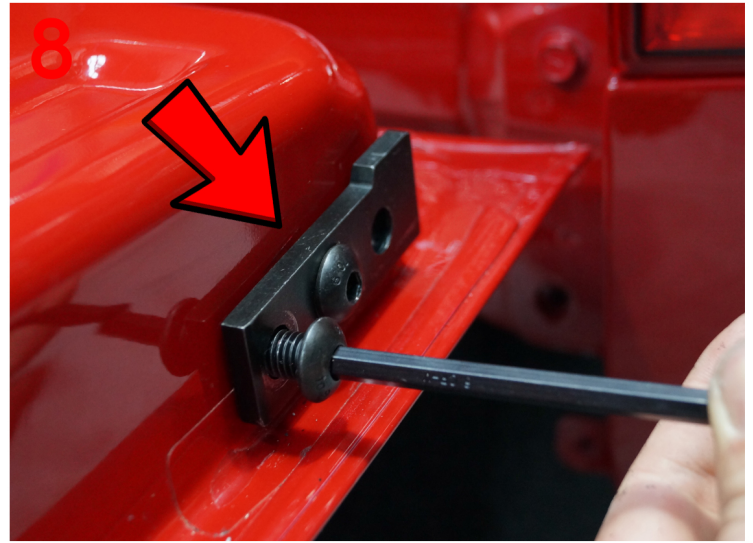

8: Insert only 2 bolts through the bracket as shown. The 3rd bolt is installed later in step 12



9: Remove the lower striker bolt from the tub



10: Install the strut and new cable supplied as shown



11: Tighten the bolt as shown



12: Place the bottom of the strut over the tailgate bracket and screw in the 3rd bolt

# Tail. Assist

INSTALLATION INSTRUCTIONS NISSAN NP300 SLOW DOWN EASY UP STRUTS  
PART NUMBER: **NP12**



13: Reinstall the cable bolt removed in step 2 placing the cable on first



14: Repeat the process on the passenger side for the EASY UP strut removing the spacer once installed



**CONGRATULATIONS ON INSTALLING  
YOUR TAIL ASSIST. EMAIL US ON  
[INFO@HSPUTELIDS.COM](mailto:INFO@HSPUTELIDS.COM) FOR ANY  
ENQUIRIES OR ISSUES WITH INSTALLATION**