



Harvey Norman®

Online | Mobile | **Your Local** Store

SHOP *with* **CONFIDENCE** on Quality, Value and Service.

Call 1300 464 278 for your local store.

Bathroom & Tiles available at the following locations: • HARVEY NORMAN FLAGSHIP STORE @ AUBURN 9202 4888 • BALGOWLAH SUPERSTORE 9949 0100 • CAMPBELLTOWN SUPERSTORE 4621 5200 • CARINGBAH HOMEMAKER CENTRE 9589 8800 • CASTLE HILL 9840 8800 • GORDON 9496 9200 • LIVERPOOL 9600 3333 • MASCOT 9693 0710 • PENRITH SUPERSTORE 4737 5111 • PUNCHBOWL 9784 4400 • BENNETTS GREEN 4944 5000 • ERINA 4365 9888 • WARRAWONG 4223 8800 • FYSHWICK 6283 1200

Harvey Norman® stores are operated by independent franchisees.



DESIGN
OUR QUALITY COMMITMENT
INNOVATION
FOCUS



CAROMA

Caroma®

Luna

Vitreous China 4.5/3 litre Dual Flush
Wall Faced Close-Coupled Toilet Suite

CI/SfB

(74.1) g3

Date

February 2015

Supersedes all previous issues

3.76.1

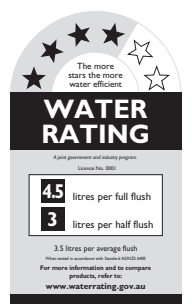



A contoured design wall faced close coupled toilet suite conceals plumbing fittings for an aesthetically pleasing finish. The pan connection system includes the patented Caroma Uni-Orbital® Connector for increased installation flexibility. The Caroma Uni-Orbital® connector extends to any position in a 50mm radius, unlike traditional connectors that only move backwards and forwards. The setout range is from 60mm – 185mm with a recommended setout of 140mm. The suite is targeted to commercial projects, but is also suitable for domestic applications. Fitted with chrome plated push buttons, the smooth sided pan design has a soft close quick release seat.

Pan: Luna 4.5 litre full flush washdown pan with box flushing rim.

Traps: Patented Caroma Uni-Orbital® connector supplied for S or P-trap installations.

Cisterns: Caroma **Universal** cistern – has a free fitting lid and is suitable for domestic and light commercial applications. Available as internal overflow. Available in either bottom inlet or back entry options. Back entry cistern inlet stop valve is concealed within the cistern. **Vandal Resistant Conversion Kit** – A simple to install conversion kit is available for the standard mechanism to lock the lid onto the cistern, recommended for use in heavy duty commercial areas. Code No.750109.

Important: Working pressure minimum 30kPa to maximum 1000kPa flow pressure. Rain water tank compliant. Accurate wall setout for B.S.P. 1/2" Nipple water inlet connection is essential.

Fixing: The cistern is fixed directly to the pan with a robust concealed base fixing system without the need for wall fixing.

Seats: The **Xena** soft close quick release thermoset toilet seat is provided as standard with this suite. See chapter 5.01 SEATS of the Caroma Technical Manual for further details.

Colours: White only.

Installation: The installation of the toilet suite shall be in accordance with the normal minimum drainline grade requirements in AS/NZS 3500.2.

Dimensions: All dimensions are in millimetres and are subject to normal manufacturing variations. Caroma pursues a policy of continuing improvement in design and performance of its products. The right is therefore reserved to vary specifications without notice.

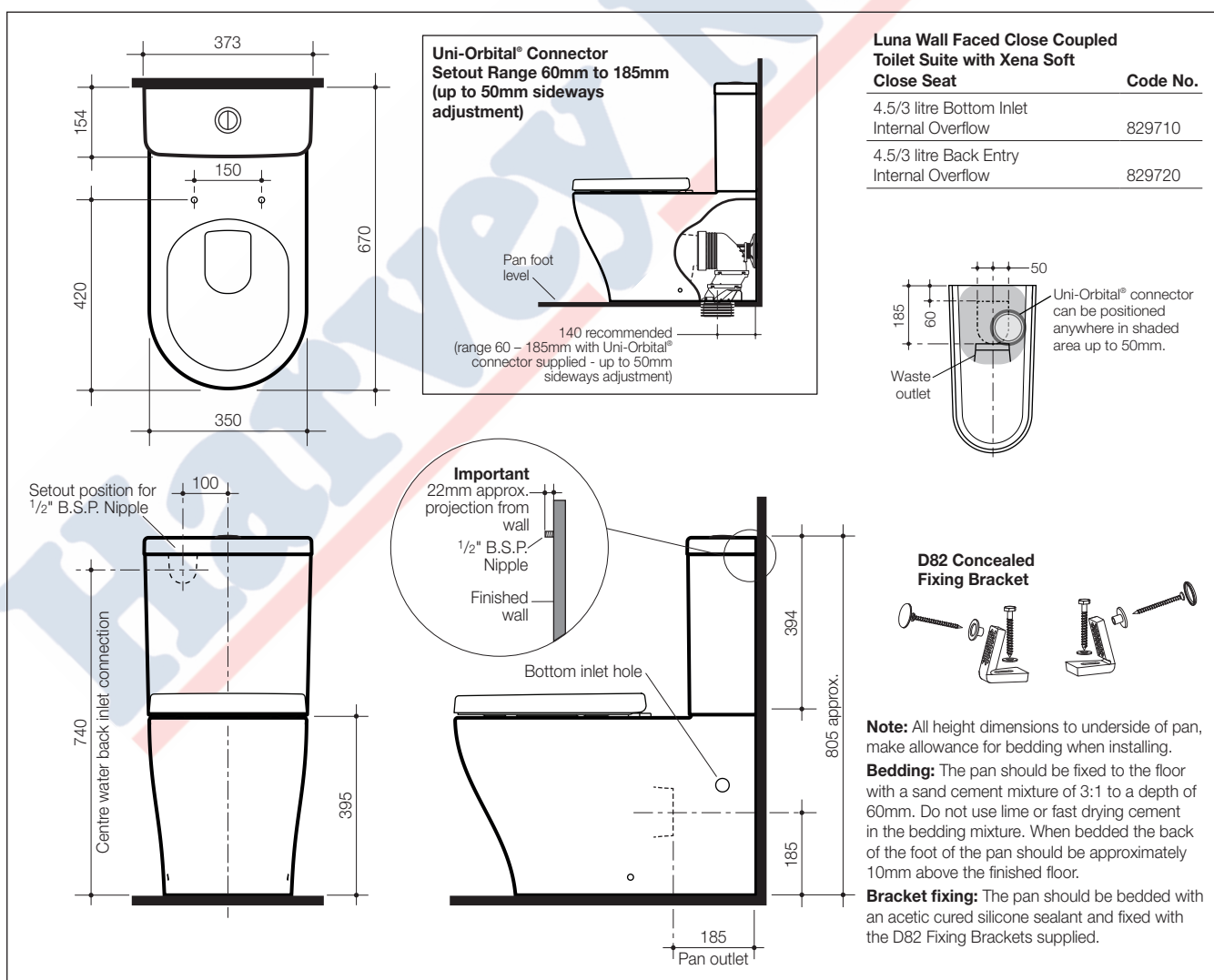

Caroma®

Urbane

Vitreous China 4.5/3 litre Dual Flush
Wall Faced Close-Coupled Toilet Suite

CI/SfB

(74.1) | g3 |

Date

November 2016

Supersedes all previous issues

3.82.1



Caroma®

Urbane

Vitreous China 4.5/3 litre Dual Flush Wall Faced Close-Coupled Toilet Suite



Back entry version of pan pictured



Bottom inlet version of pan pictured

A universal design, the wall faced toilet suite conceals plumbing fittings for an aesthetically pleasing finish. The pan connection system includes the patented Caroma Uni-Orbital® Connector for increased installation flexibility. The Caroma Uni-Orbital® Connector extends to any position in a 50mm radius, unlike traditional connectors that only move backwards and forwards. The setout range is from 60mm – 200mm with a recommended setout of 140mm. The suite is suitable for use in domestic and commercial projects, and also for ambulant applications. Fitted with chrome plated metal push buttons, the smooth sided pan design offers a seamless finish to your bathroom.

Pan: **Urbane** 4.5 litre full flush washdown pan with box rim.

Traps: Universal trap for S or P-trap installations.

Cisterns: **Urbane** close coupled cistern – has a free fitting lid and is suitable for domestic and light commercial applications. Available with internal overflow. Available in either back entry or bottom inlet options.

Cistern inlet stop valve and inlet connection is concealed within the cistern and is included. **Vandal Resistant Conversion Kit** – A simple to install conversion is available for the standard mechanism to lock lid onto the cistern, recommended for use in heavy use commercial areas. Code No.750109.

Important: Working pressure minimum 30kPa to maximum 1000kPa flow pressure. Rain water tank compliant. Accurate wall setout for B.S.P. 1/2" Nipple water inlet connection is essential.

Fixing: The cistern is fixed directly to the pan with a robust concealed base fixing system without the need for wall fixing.

Seats: The **Arc** soft close thermoset toilet seat is provided as standard with the Urbane suite. See chapter 5.01 SEATS of the Caroma Technical Manual for further details.

Colours: White only.

Installation: The installation of the toilet suite shall be in accordance with the normal minimum drainline grade requirements in AS/NZS 3500.2.

Dimensions: All dimensions are in millimetres and are subject to normal manufacturing variations. Caroma pursues a policy of continuing improvement in design and performance of its products. The right is therefore reserved to vary specifications without notice.



**Uni-Orbital® Connector Setout
Range 60mm to 200mm
(up to 50mm sideways
adjustment)**

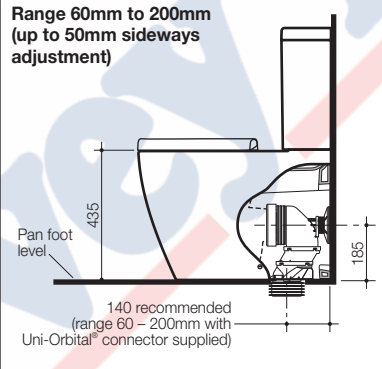

Urbane Wall Faced Close Coupled Toilet Suite with Seat

Code No.

4.5/3 litre Back Entry Internal Overflow with Arc Soft Close Seat	743500
4.5/3 litre RH Bottom Inlet Internal Overflow with Arc Soft Close Seat	744500

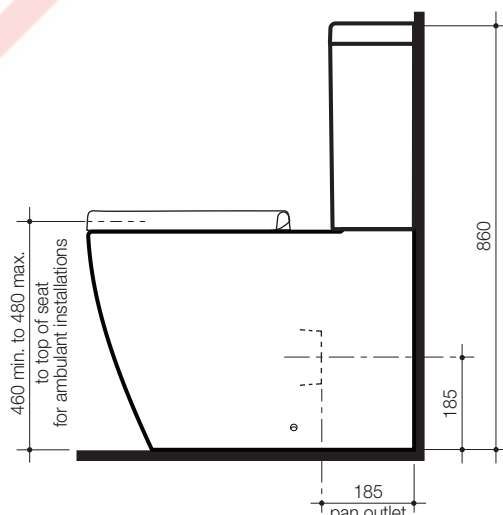
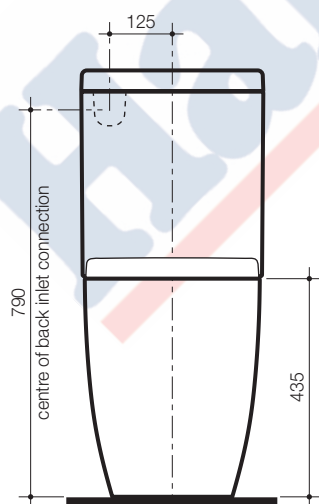

D82 Concealed Fixing Bracket

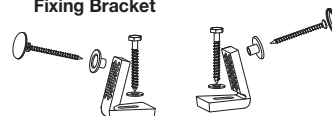

Note: All height dimensions to underside of pan, make allowance for bedding when installing.

Bedding: The pan should be fixed to the floor with a sand cement mixture of 3:1 to a depth of 60mm. Do not use lime or fast drying cement in the bedding mixture. When bedded the back of the foot of the pan should be approximately 10mm above the finished floor.

Bracket fixing: The pan should be bedded with an acetic cured silicone sealant and fixed with the D82 Fixing Brackets supplied.

Caroma®

CI/SfB

(74.1) | g3 |

Date

October 2015

Supersedes all previous issues

Urbane Invisi II

3.83.1

4.5/3 litre Dual Flush Toilet Suite with
Urbane Wall Faced Box Rim Vitreous China Pan
and Invisi II Cistern for Inwall, Under Counter,
Induct or Inceiling applications

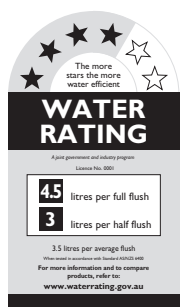

Caroma®

Urbane Invisi II

4.5/3 litre Dual Flush Toilet Suite with Urbane Vitreous China Wall Faced Box Rim Pan and Invisi II Cistern for Inwall, Under Counter, Induct or Inceiling applications



Pictured with Caroma Arc Soft Close seat

A classic designed wall faced concealed toilet suite comprises the **Urbane** pan and trusted Caroma **Invisi II** cistern suitable for use in domestic and commercial projects. The pan connection system includes the patented Caroma Uni-Orbital® Connector extends to any position in a 50mm radius, unlike traditional connectors that only move backwards and forwards. The setout range is from 60mm – 120mm with a recommended setout of 90mm. The smooth sided pan matched with the concealed cistern offer a seamless finish to your bathroom. Choose from a variety of buttons from the Caroma range to complete your desired look.

- Pan:** Urbane wall faced back inlet 4.5 litre full flush box rim pan
- Traps:** Universal trap for S or P-trap installations.
- Inlet:** Fully glazed 50mm back inlet for concealed cistern and flushvalve installation.
- Cisterns and Flushvalves:** **Invisi II Cistern** – suitable for inwall, under counter, induct and in ceiling applications. For push button and access plate (supplied separately) options see chapter 6.15.1 CISTERNS of the Caroma Technical Manual.
- Fixing:** The pan can be fixed to the floor by either bedding into mortar or using the D82 Concealed Fixing Bracket.
- Seats:** The **Arc** soft close thermoset toilet seat is provided as standard with the Urbane suite. See chapter 5.01 SEATS of the Caroma Technical Manual for further details.
- Colours:** White only.
- Installation:** The installation of the toilet suite shall be in accordance with the normal minimum drainline grade requirements in AS/NZS 3500.2.
- Dimensions:** All dimensions are in millimetres and are subject to normal manufacturing variations. Caroma pursues a policy of continuing improvement in design and performance of its products. The right is therefore reserved to vary specifications without notice.

Urbane Invisi II Wall Faced Suite Inwall/Under Counter Installations

Urbane Invisi II 4.5/3 litre Wall Faced Toilet Suite with Back Inlet Pan, Internal Overflow Cistern and Seat:

Code No.

Inwall/Under Counter/Induct/Inceiling
with Arc Soft Close Seat
Button options: see 6.15.1

742500

Inwall Installation

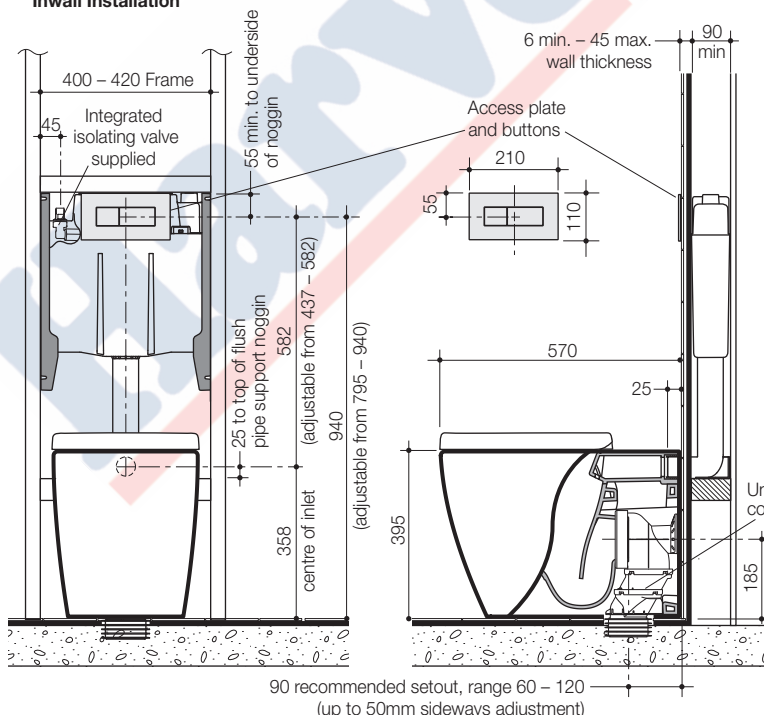

Under Counter Installation

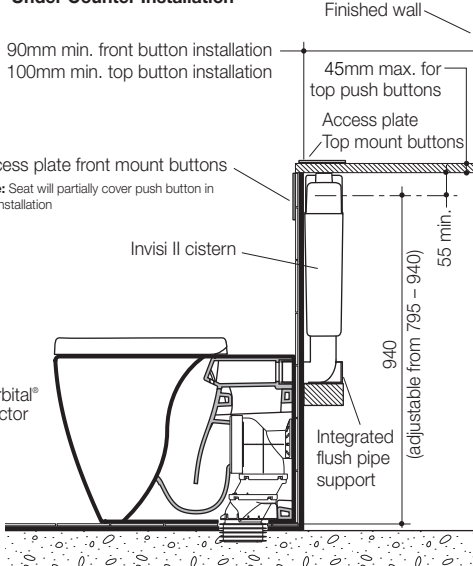

Note: access to cistern internals can be achieved through either front or top mount button plate option.

Caroma®

Contura

Vitreous China 4.5/3 litre Dual Flush
Wall Faced Close-Coupled Toilet Suite

CI/SfB

(74.1) g3

Date

March 2015

Supersedes all previous issues

3.87.1

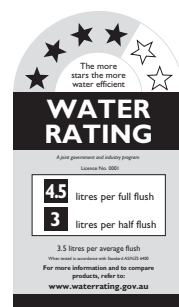

Caroma®

Contura

Vitreous China 4.5/3 litre Dual Flush Wall Faced Close-Coupled Toilet Suite



With a curvaceous and organic design to elevate your bathroom surroundings, the **Contura** wall faced close coupled toilet suite brings soul to your functional bathroom products. The pan connection system includes the patented Caroma Uni-Orbital® connector for increased installation flexibility. The Caroma Uni-Orbital® connector extends to any position up to a 50mm radius, unlike traditional connectors that only move backwards and forwards. The setout range is from 60mm – 225mm with a recommended setout of 140mm. The suite is suitable for commercial projects and domestic applications. Fitted with chrome plated push buttons, the smooth sided pan design with a contoured seat offer a seamless integration for simple luxury.

- Pan:** **Contura** 4.5 litre full flush washdown pan with a fully glazed rim and trap.
- Traps:** Universal trap for S or P-trap installations.
- Cistern:** **Contura** cistern shroud conceals an integrated dual flush cistern and is suitable for domestic and light commercial applications. Available as internal overflow. Standard back entry only. Cistern inlet stop valve and inlet flex tube connection is concealed within the cistern shroud and is included.
- Vandal Resistant System** – A vandal resistant system is incorporated to lock the shroud onto the cistern tank.
- Important: Working pressure minimum 30kPa to maximum 1000kPa flow pressure. Rain water tank compliant. Accurate wall setout for B.S.P. 1/2" Nipple water inlet connection is essential.**
- Fixing:** The cistern tank is fixed directly to the pan with a robust concealed base fixing system without the need for wall fixing.
- Seats:** The **Contura** soft close toilet seat is provided as standard with the Contura suite. A quality solid section compression moulded toilet seat, fitted with buffers and metal hinges.
- Colours:** White only.
- Installation:** The installation of the toilet suite shall be in accordance with the normal minimum drainline grade requirements in AS/NZS 3500.2.
- Dimensions:** All dimensions are in millimetres and are subject to normal manufacturing variations. Caroma pursues a policy of continuing improvement in design and performance of its products. The right is therefore reserved to vary specifications without notice.

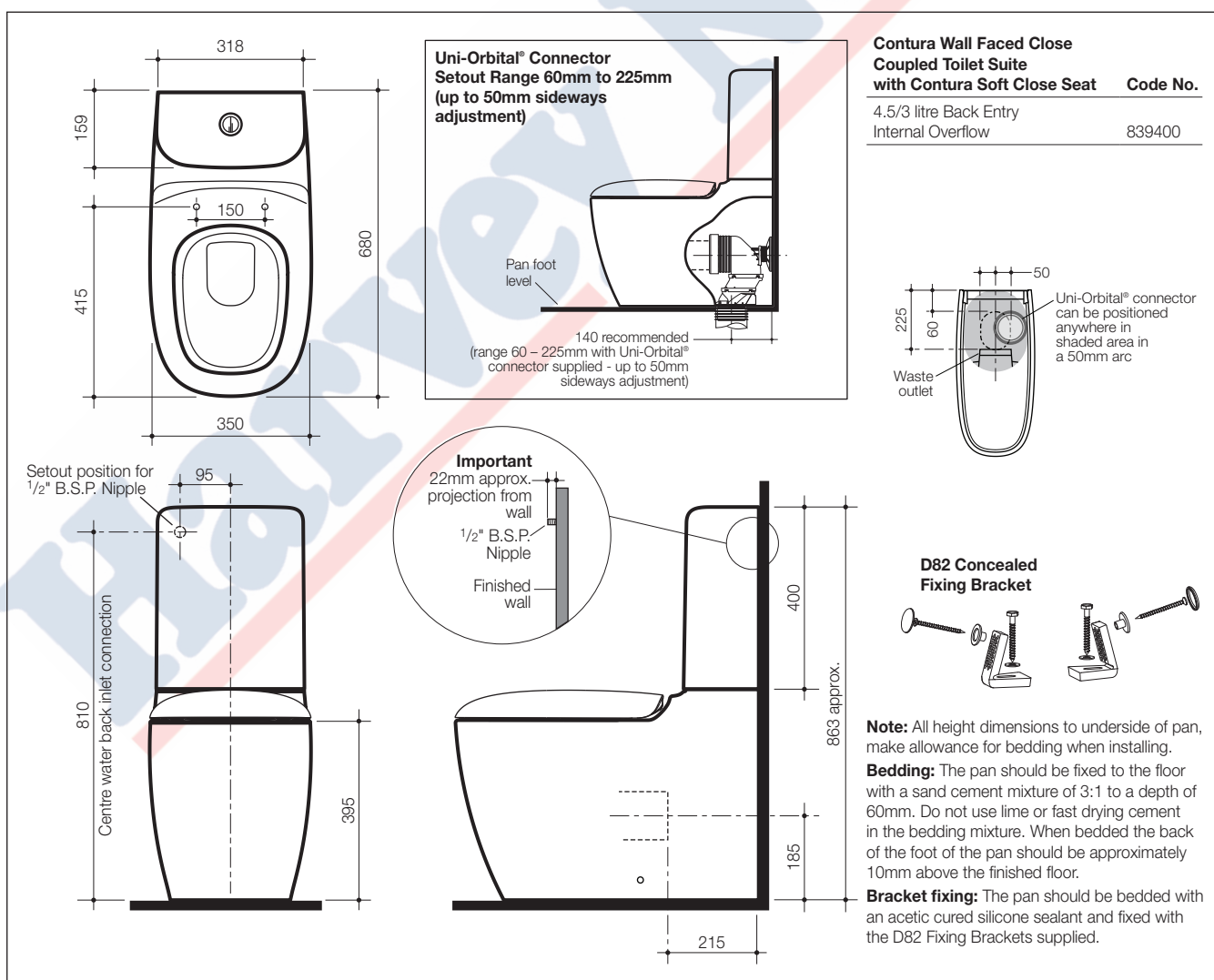

Caroma®

Metro

Vitreous China 4.5/3 litre Dual Flush
Wall Faced Close-Coupled Box Rim Toilet Suite

CI/SfB	(74.1)	g3
Date	October 2014	

3.33.1

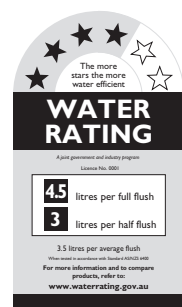



A versatile wall faced close-coupled toilet suite featuring a compact 4.5/3 litre dual flush cistern with low profile chrome plated push buttons and a universal connection system for varying pan setouts. The **Metro** suite has been designed to provide low cost maintenance by incorporating easy to clean rounded surfaces combined with smooth sides. The pan connection system includes the patented Caroma Uni-Orbital® connector for increased installation flexibility. The Caroma Uni-Orbital® connector extends to any position in a 25mm radius, unlike traditional connectors that only move backwards and forwards. The setout range is from 60mm – 220mm with a recommended setout of 140mm. The suite has been developed to meet the needs of a modern Australian industry to provide the designer with the ultimate water-saving technology vitreous china toilet suite. The cistern is fitted with an ultra quiet fast fill inlet valve as standard.

Pan: **Metro** 4.5 litre full flush washdown pan with box flushing rim.

Traps: Universal trap for S or P-trap installations.

Cisterns: **Metro** cistern – has a free fitting lid and is suitable for domestic and light commercial applications. Available in either bottom inlet or back entry options. Back entry cistern inlet stop valve is concealed within the cistern.

Vandal Resistant Conversion Kit – A simple to install conversion is available for the standard mechanism to lock lid onto the cistern, recommended for use in heavy use commercial areas. Code No.750109.

Important: Working pressure minimum 30kPa to maximum 1000kPa flow pressure. Rain water tank compliant. Accurate wall setout for B.S.P. 1/2" Nipple water inlet connection is essential.

Fixing: The cistern is fixed directly to the pan with a robust concealed base fixing system without the need for wall fixing.

Seats: The **Metro toilet** seat or **Metro** soft close toilet seat is provided as standard with the Metro suite.

Colours: White only.

Installation: The installation of the toilet suite shall be in accordance with the normal minimum drainline grade requirements in AS/NZS 3500.2.

Dimensions: All dimensions are in millimetres and are subject to normal manufacturing variations. Caroma pursues a policy of continuing improvement in design and performance of its products. The right is therefore reserved to vary specifications without notice.

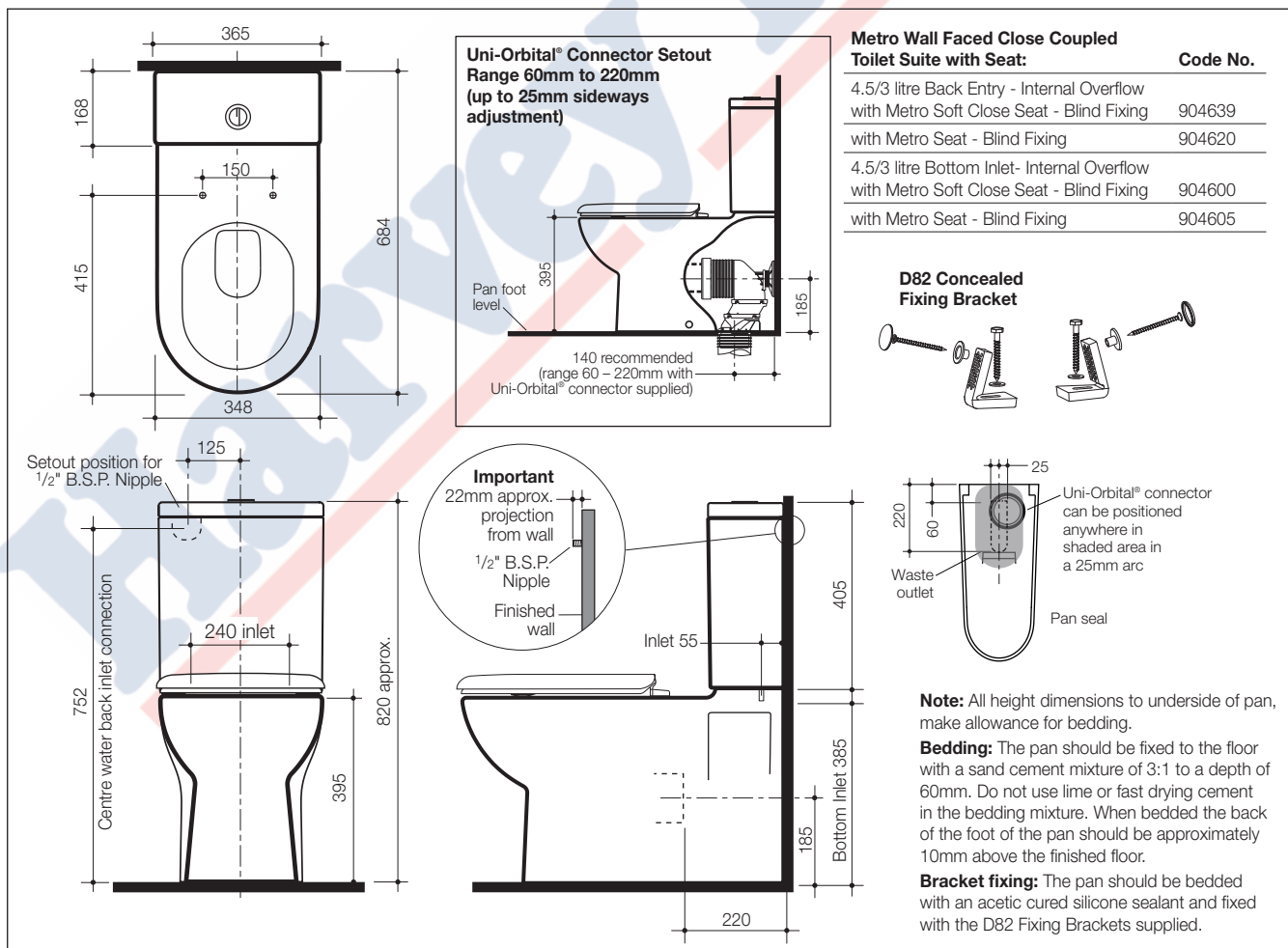

Caroma®

Morgana

Vitreous China 4.5/3 litre Dual Flush
Wall Faced Close-Coupled Toilet Suite

CI/SfB	(74.1)	g3
Date	February 2015	

Supersedes all previous issues

3.76.1

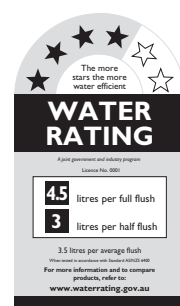

Caroma®

Morgana

Vitreous China 4.5/3 litre Dual Flush Wall Faced Close-Coupled Toilet Suite



A square and smooth design for a contemporary look and feel, the **Morgana** wall faced close coupled toilet suite conceals plumbing fittings for an aesthetically pleasing finish. The pan connection system includes the patented Caroma Uni-Orbital® connector for increased installation flexibility. The Caroma Uni-Orbital® connector extends to any position in a 50mm radius, unlike traditional connectors that only move backwards and forwards. The setout range is from 60mm – 170mm with a recommended setout of 140mm. The suite is targeted to commercial projects, but is also suitable for domestic applications.

Pan: **Morgana** 4.5 litre full flush washdown pan with box flushing rim.

Traps: Patented Caroma Uni-Orbital® connector supplied for S or P-trap installations.

Cisterns: Caroma **Universal** cistern – has a free fitting lid and is suitable for domestic and light commercial applications. Available as internal overflow. Available in either bottom inlet or back entry options. Back entry cistern inlet stop valve is concealed within the cistern. **Vandal Resistant Conversion Kit** – A simple to install conversion kit is available for the standard mechanism to lock the lid onto the cistern, recommended for use in heavy duty commercial areas. Code No.750109.

Important: Working pressure minimum 30kPa to maximum 1000kPa flow pressure. Rain water tank compliant. Accurate wall setout for B.S.P. 1/2" Nipple water inlet connection is essential.

Fixing: The cistern is fixed directly to the pan with a robust concealed base fixing system without the need for wall fixing.

Seats: The **Morgana** soft close quick release thermoset toilet seat is provided as standard with this suite. See chapter 5.01 SEATS of the Caroma Technical Manual for further details.

Colours: White only.

Installation: The installation of the toilet suite shall be in accordance with the normal minimum drainline grade requirements in AS/NZS 3500.2.

Dimensions: All dimensions are in millimetres and are subject to normal manufacturing variations. Caroma pursues a policy of continuing improvement in design and performance of its products. The right is therefore reserved to vary specifications without notice.

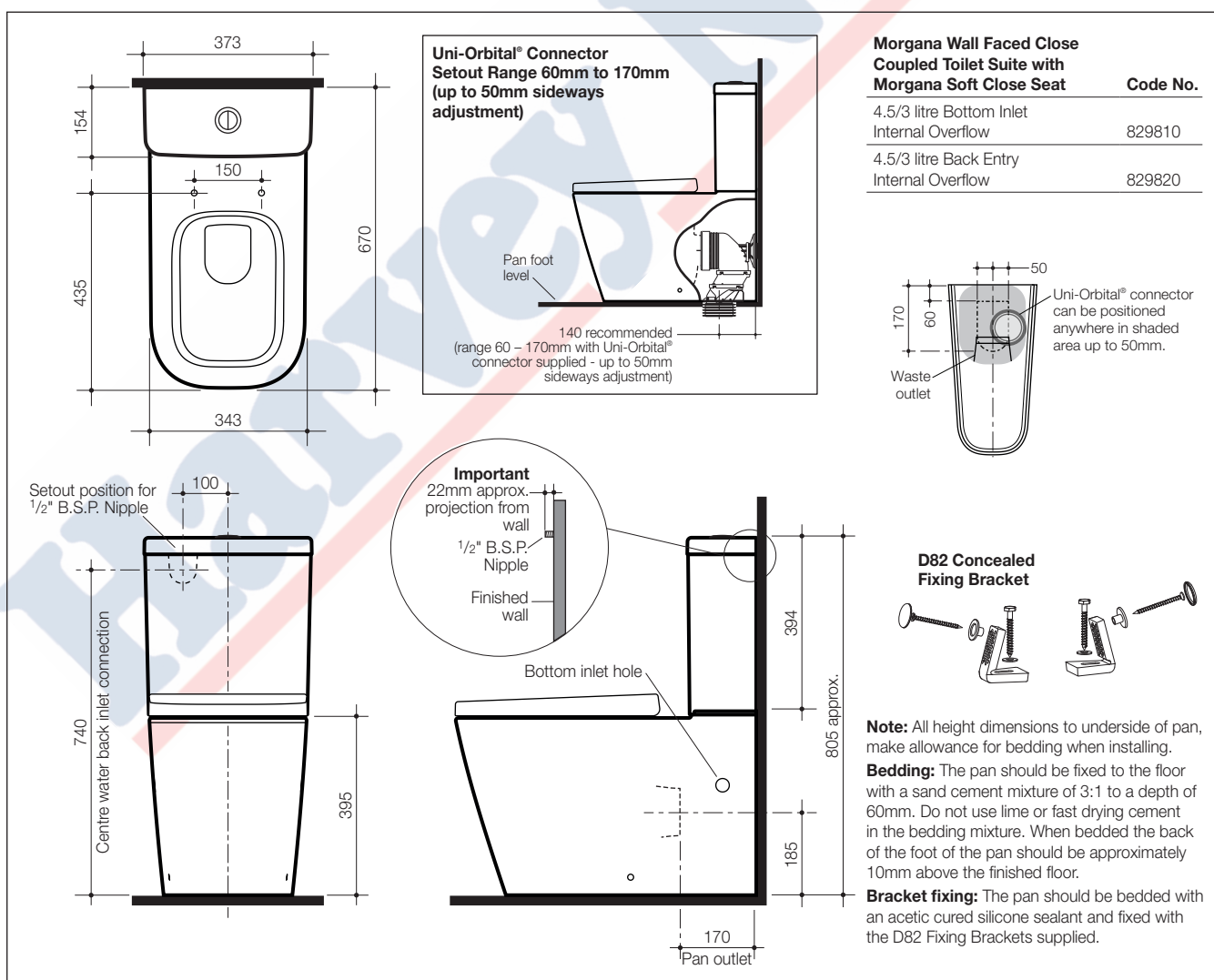

Caroma®

Opal

Vitreous China 4.5/3 litre Dual Flush
Wall Faced Close-Coupled Toilet Suite

CI/SfB	(74.1)	g3
Date		
May 2015		

Supersedes all previous issues

3.23.3

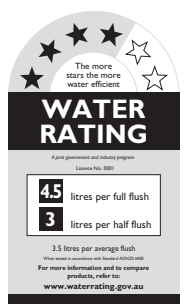



A fully integrated wall faced close-coupled toilet suite featuring a compact 4.5/3 litre dual flush cistern with low profile chrome plated push buttons and a universal connection system for varying pan setouts. The suite has been designed to provide low cost maintenance by incorporating easy to clean rounded surfaces, combined with the advantages of a wall faced pan. The suite is supplied with a bottom inlet cistern and a back entry conversion kit. The pan connection system includes the patented Caroma Uni-Orbital® connector for increased installation flexibility. The Caroma Uni-Orbital® connector extends to any position in a 25mm radius, unlike traditional connectors that only move backwards and forwards. The setout range is from 60mm – 220mm with a recommended setout of 140mm, providing installation versatility for both new and renovation applications.

Pan: Opal 4.5 litre full flush washdown pan with open flushing rim.

Traps: Universal trap for S or P-trap installations. 50mm vent option available.

Cisterns: Opal cistern – has a free fitting lid and is suitable for domestic and light commercial applications. Available as internal overflow. Standard bottom inlet with back entry conversion kit.

Vandal Resistant Conversion Kit – A simple to install conversion is available for the standard mechanism to lock lid onto the cistern, recommended for use in heavy use commercial areas. Code No.750109. Cistern inlet stop valve and inlet flex tube connection is concealed on the back entry installation within the cistern and is included.

Important: Working pressure minimum 30kPa to maximum 1000kPa flow pressure. Rain water tank compliant. Accurate wall setout for B.S.P. 1/2" Nipple water inlet connection is essential.

Fixing: The cistern is fixed directly to the pan with a robust concealed base fixing system without the need for wall fixing.

Seats: The **Avalon Commercial** toilet seat or **Avalon Commercial** soft close toilet seat is provided as standard with the Opal suite. A quality solid section compression moulded toilet seat fitted with buffers and chrome hinges.

Colours: White only.

Installation: The installation of the toilet suite shall be in accordance with the normal minimum drainline grade requirements in AS/NZS 3500.2.

Dimensions: All dimensions are in millimetres and are subject to normal manufacturing variations. Caroma pursues a policy of continuing improvement in design and performance of its products. The right is therefore reserved to vary specifications without notice.

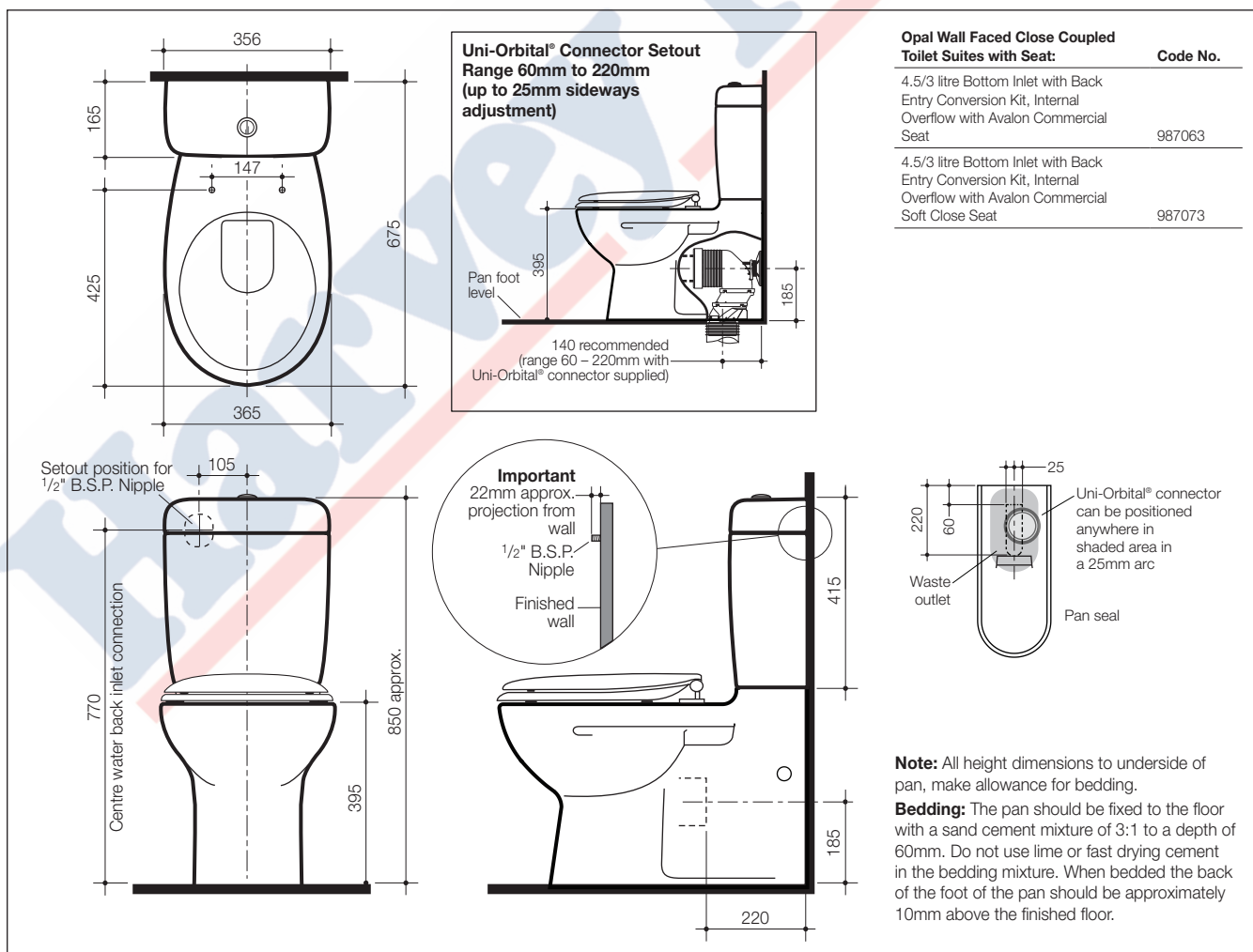

Caroma®

Stirling

Vitreous China 4.5/3 litre Dual Flush
Wall Faced Close-Coupled Toilet Suite

CI/SfB	(74.1)	g3
Date	May 2015	

Supersedes all previous issues

3.23.4

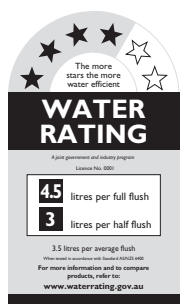

Caroma®

Stirling

Vitreous China 4.5/3 litre Dual Flush Wall Faced Close-Coupled Toilet Suite



A fully integrated wall faced close-coupled Smartflush toilet suite featuring a compact 4.5/3 litre dual flush cistern with low profile chrome plated push buttons and a universal connection system for varying pan setouts. The **Stirling** suite has been designed to provide low cost maintenance by incorporating easy to clean rounded surfaces combined with the advantages of a wall faced pan. The suite is supplied with a bottom inlet cistern and a back entry conversion kit. Back entry option completely conceals both the inlet and stop valve and outlet connections. The pan connection system includes the patented Caroma Uni-Orbital® connector for increased installation flexibility. The Caroma Uni-Orbital® connector extends to any position in a 25mm radius, unlike traditional connectors that only move backwards and forwards. The setout range is from 60mm – 220mm with a recommended setout of 140mm, providing installation versatility for both new and renovation applications.

- Pan:** Opal 4.5 litre full flush washdown pan with open flushing rim.
- Traps:** Universal trap for S or P-trap installations.
- Cisterns:** **Stirling** cistern – has a free fitting lid and is suitable for domestic and light commercial applications. Available as internal overflow. Standard bottom inlet with back entry conversion kit.
- Vandal Resistant Conversion Kit** – A simple to install conversion kit is available for the standard mechanism to lock the lid onto the cistern, recommended for use in heavy duty commercial areas. Code No.750109.
- Cistern inlet stop valve and inlet flex tube connection is concealed on the back entry installation within the cistern and is included.
- Important: Working pressure minimum 30kPa to maximum 1000kPa flow pressure. Rain water tank compliant. Accurate wall setout for B.S.P. 1/2" Nipple water inlet connection is essential.**

- Fixing:** The cistern is fixed directly to the pan with a robust concealed base fixing system without the need for wall fixing.
- Seats:** The **Stirling** soft close toilet seat is provided as standard with the Stirling suite. The seat features a easy quick release mechanism that allows for cleaning. A quality solid section toilet seat fitted with buffers and stainless steel hinges.
- Colours:** White only.
- Installation:** The installation of the toilet suite shall be in accordance with the normal minimum drainline grade requirements in AS/NZS 3500.2.
- Dimensions:** All dimensions are in millimetres and are subject to normal manufacturing variations. Caroma pursues a policy of continuing improvement in design and performance of its products. The right is therefore reserved to vary specifications without notice.

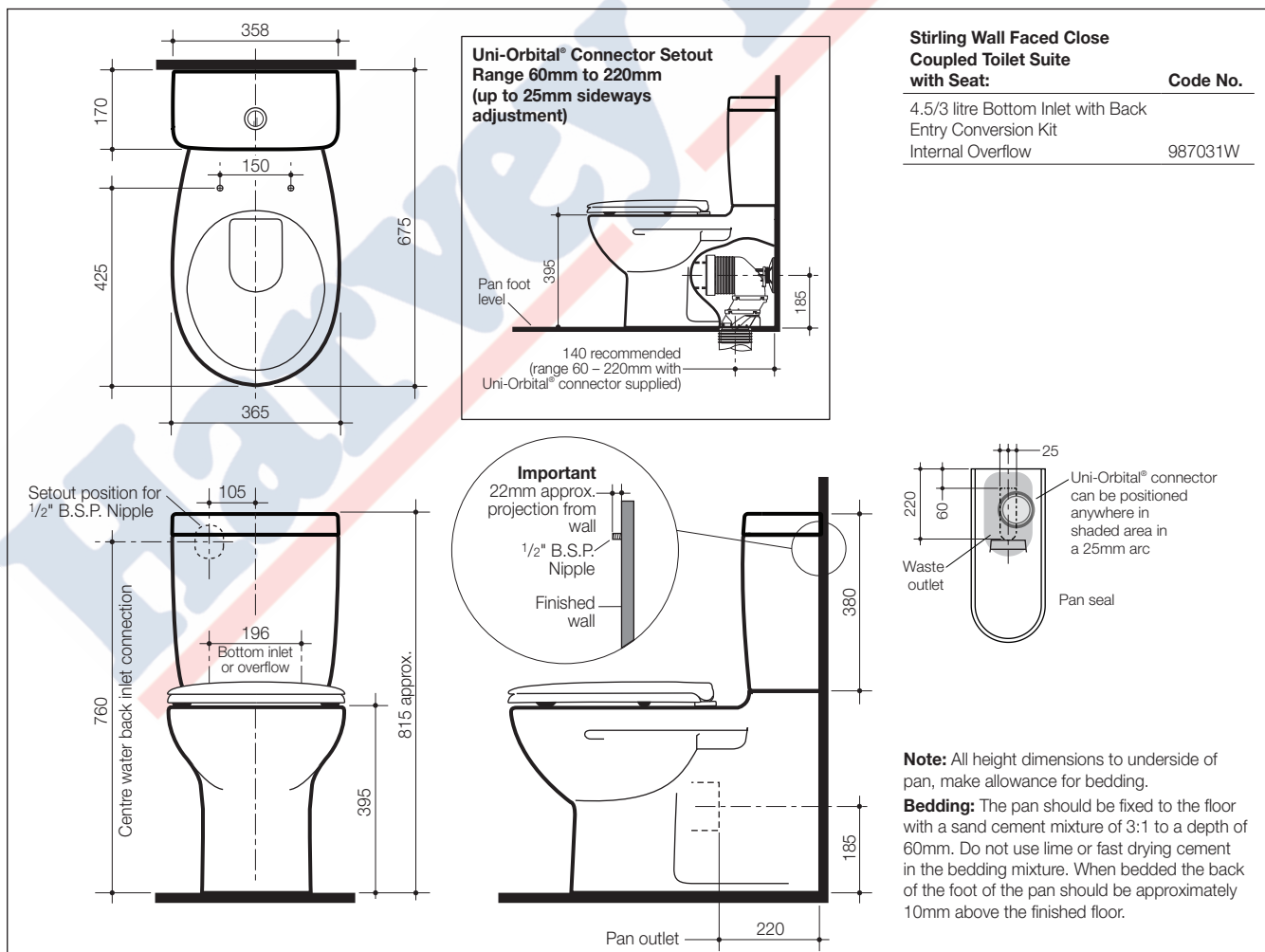

Caroma®

Cameo

**Vitreous China 4.5/3 litre Dual Flush
Close-Coupled Toilet Suite**

**Designed with the patented Orbital®
50mm Variable Offset Connector**

CI/SfB	(74.1)	g3
Date	May 2015	

Supersedes all previous issues

3.24.2



S trap suite pictured

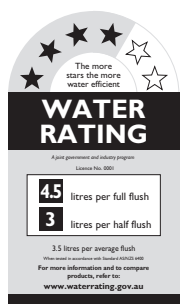

Caroma®

Cameo

Vitreous China 4.5/3 litre Dual Flush Close-Coupled Toilet Suite



S Trap suite



P Trap suite

A close-coupled suite with smooth round corners and a concealed trap for ease of cleaning. The suite is supplied with the Caroma Orbital® connector, a patented 50mm variable offset connector for increased flexibility on setout. The **Cameo** cistern is an integrated system with a high performance outlet valve, fitted with low profile push buttons and is available in a 1/2" B.S.P. back entry option which completely conceals the inlet stop valve and connections for optimum installation appearance.

Pan: **Cameo** 4.5 litre full flush washdown pan with open flushing rim. Features the Caroma Orbital® 50mm variable offset connector.

Traps: S and P trap unvented.

Cisterns: **Cameo** cistern – has a free fitting lid and is suitable for domestic and light commercial applications.

Vandal Resistant Conversion Kit – A simple to install conversion kit is available for the standard mechanism to lock the lid onto the cistern, recommended for use in heavy duty commercial areas. Code No.750109.

Inlet Valve and Overflow: **Standard Bottom Inlet Cistern** – available as right hand inlet which is interchangeable and incorporates the Apollo inlet valve. Internal overflow only.

Back Entry Cistern – An optional back entry conversion kit is available to convert the cistern from right hand bottom inlet to concealed back entry. Code No.687254.

Important: Working pressure minimum 30kPa to maximum 1000kPa flow pressure. Rain water tank compliant. Accurate wall setout for B.S.P. 1/2" Nipple water inlet connection is essential.

Fixing: The cistern is fixed directly to the pan with a robust base fixing system without the need for wall fixing.

Seats: The **Profile** seat is provided as standard with the Cameo suite in both soft close or standard hinge options.

Colours: White only.

Installation: The installation of the toilet suite shall be in accordance with the normal minimum drainline grade requirements in AS/NZS 3500.2.

Dimensions: All dimensions are in millimetres and are subject to normal manufacturing variations. Caroma pursues a policy of continuing improvement in design and performance of its products. The right is therefore reserved to vary specifications without notice.

